



EAGLE
NATURAL RESOURCES

Crossbow Joint Venture

**Multi-Project Horizontal Well
Development Program**

**Powder River Basin (Core)
Campbell County, Wyoming**

Eight New Horizontal Wells

Two Projects

Two Leases

Two Operators

Two Different Formations

(Six Niobrara Wells and Two Mowry Wells)

Seven Wells Completed (Pending Production)

One Well Permitted (To Drill)

**1.912500% (Avg) Non-Operated Working Interest
1.4343750% (Avg) Net Revenue Interest (in Each Well)**

Available for \$3.6MM

Crossbow Joint Venture

Multi-Project Horizontal Well Development Program
Powder River Basin (Core), Campbell County, Wyoming



EAGLE
NATURAL RESOURCES

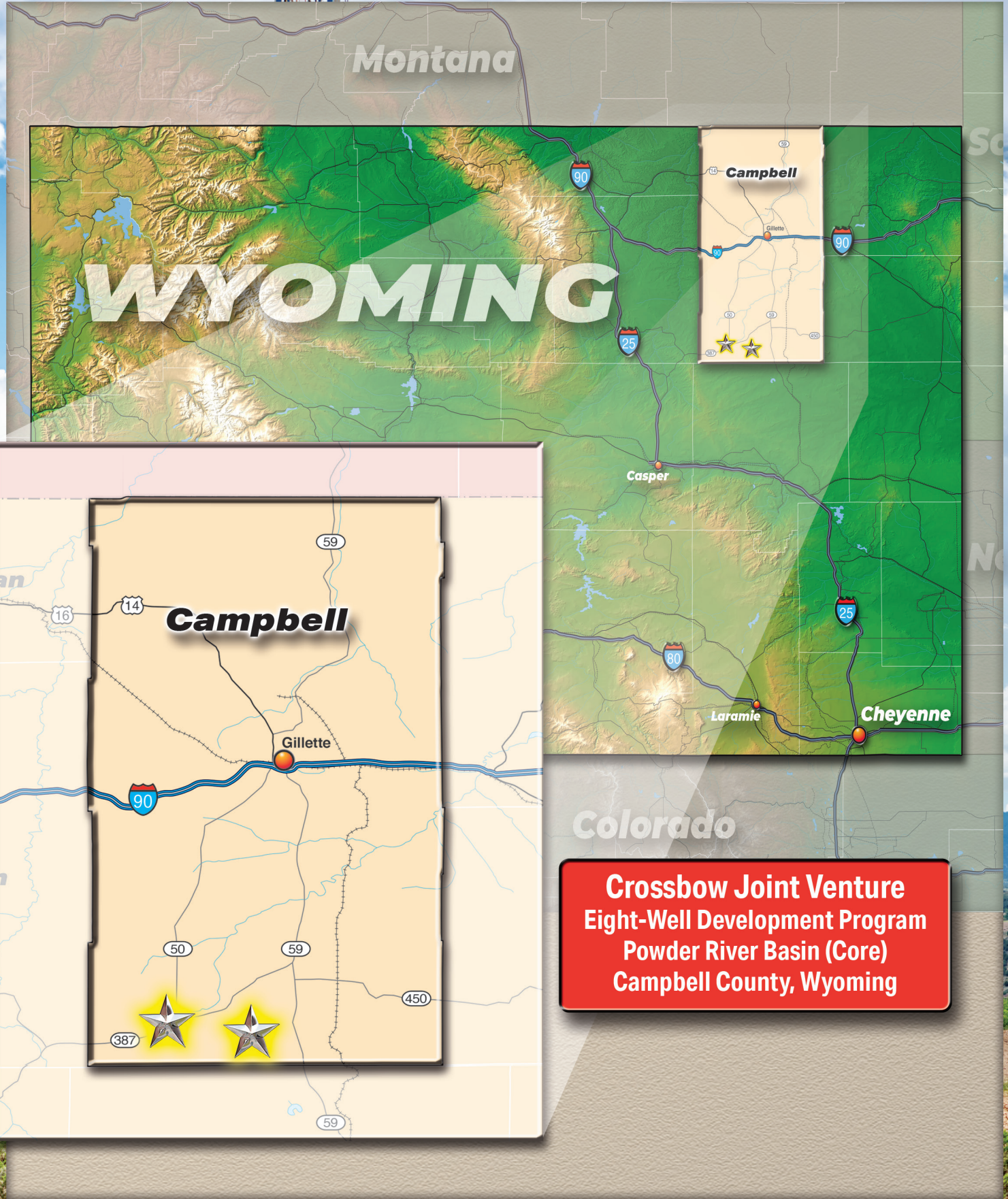

Crossbow Joint Venture

Multi-Project Horizontal Well Development Program
Powder River Basin (Core), Campbell County, Wyoming



EAGLE
NATURAL RESOURCES

Crossbow Joint Venture – Low-Risk Horizontal Development

Powder River Basin (Core) – Campbell County, Wyoming

The Crossbow Joint Venture involves the drilling and completion of eight new horizontal wells with two different operators, EOG Resources and Peak Powder Resources, located in the prolific Powder River Basin in Campbell County, Wyoming. Crossbow is comprised of two different projects with the current status of the eight wells as follows: 1) seven wells completed (pending production and 2) one well permitted (to drill).

Powder River Basin – Oil and Gas Map

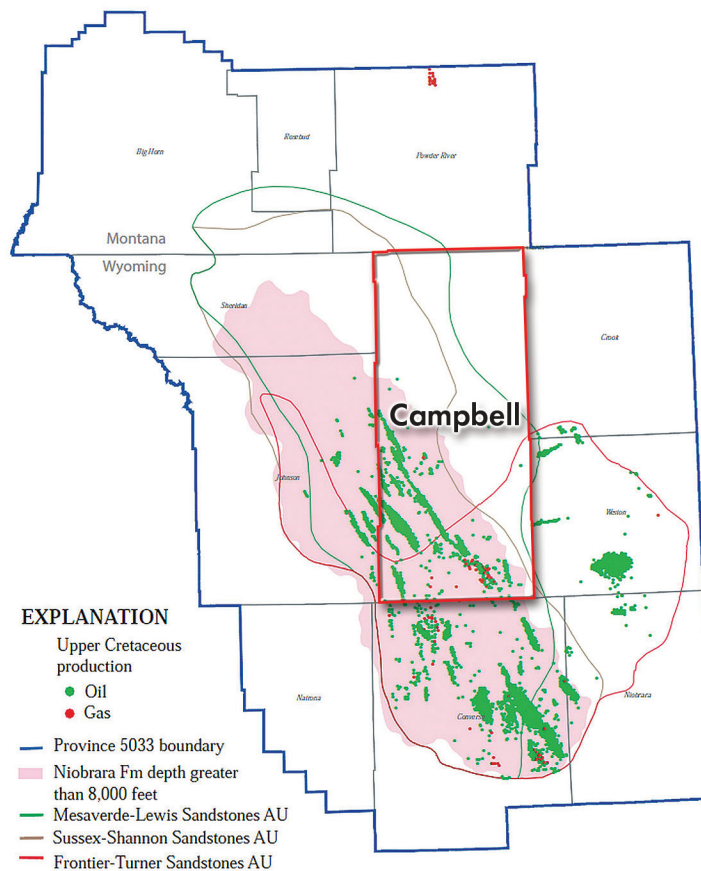

The Powder River Basin is emerging as a world class oil and gas basin, and currently has thirteen drilling rigs active in the basin, which is six more rigs than the seven rigs active in the prolific DJ Basin in Colorado to the south. Like the DJ Basin, the Powder River Basin is an established oil shale resource play and considered a very low geologic-risk drilling opportunity in several different prospective formation targets. The “stacked” formation targets of the Powder River Basin allows a “shared risk” approach to oil and gas development. In the two different projects in Crossbow, there are two different formations that will be targeted: 6 Niobrara wells and 2 Mowry wells. Both of these horizontal formations (shown on the Stratigraphic Chart) already produce in the offset horizontal wells (used in the Analog Production Study), and both formations respond very well to horizontal drilling and multi-stage fracturing. The ongoing development of the unconventional resources of the Powder River Basin can be considered more of a “mining process” than a true exploration or “wildcatting” play, since the oil is already in-place, and horizontal drilling and multi-stage hydraulic fracturing can be used to extract the oil economically.

Crossbow Joint Venture

Multi-Project Horizontal Well Development Program
Powder River Basin (Core), Campbell County, Wyoming



EAGLE
NATURAL RESOURCES

Crossbow Joint Venture – Low-Risk Horizontal Development

Powder River Basin (Core) – Campbell County, Wyoming

Powder River Basin – Stratigraphic Chart

Era	System / Series	Western Powder River	Eastern Powder River			
Cenozoic	Tertiary	Miocene				
		Oligocene	White River Fm.	White River Fm.		
		Eocene	Wasatch Fm.	Wasatch Fm.		
		Paleocene	Fort Union Fm.	Tongue River Mbr. Lebo Sh. Mbr. Tulloch Mbr.	Fort Union Fm.	
	Mesozoic		Cretaceous	Upper	Lance Fm. Fox Hills Ss. Lewis Sh. Teekla Ss. Mbr. Teapot Ss. Mbr. Parkman Ss. Mbr. Claggett Sh. Mbr. Sussex Ss. Mbr. Eagle Sh. Mbr. Saannon Ss. Mbr. Steele Sh. Mbr. Niobrara Ss. Mbr. Carlisle Sh. Mbr.	Lance Fm. Hell Creek Fm. Fox Hills Ss. Pierre Shale Niobrara Sh Mbr. Turner Sandy Mbr. Pool Creek Mbr. Greenhorn Fm. Belle Fourche Sh. Mowry Sh. Muddy Ss. Skull Creek Sh.
				Lower	Thermopolis Sh. Fall River Fm. (Dakota) Fuson Shale Lakota Fm.	Thermopolis Sh. Fall River Fm. (Dakota) Fuson Shale Lakota Fm.
	Jurassic	Sundance Formation		Morrison Fm.	Morrison Fm. Redwater Sh. Mbr. Pine Butte Mbr. Lax Mbr. Halle Mbr. Stockade Beaver Sh. Mbr. Canyon Springs Ss. Mbr.	
				Gypsum Spring Fm.	Gypsum Spring Fm.	

Project 1 (Reyes) consists of drilling four new horizontal Niobrara wells with EOG Resources as operator, to be drilled in Campbell County, Wyoming. EOG Resources has already produced 8.7 million barrels oil and 43 billion cubic feet gas (or 16.1 million barrels oil equivalent) from 50 horizontal Niobrara wells in the Powder River Basin to date (which is an average of 322 thousand barrels oil equivalent per well). Current average per well rate is 64 barrels oil per day and 367 thousand cubic feet gas per day (or 127 barrels oil equivalent per day). Eagle is to participate in four Niobrara wells at a 2.70000% Working Interest with a 2.02500% Net Revenue Interest. Four wells completed, pending production.

Project 2 (Iberlin) consists of drilling four new horizontal wells (2 Niobrara and 2 Mowry) with Peak Powder Resources as operator, to be drilled in Campbell County, Wyoming. Eagle is to participate in the four wells at a 1.12500% Working Interest with a 0.843750% Net Revenue Interest. One Mowry well and two Niobrara wells are completed (pending production), and one Mowry well is permitted (to drill in 2025). Peak Powder Resources has produced 531 thousand barrels oil and 1.3 billion cubic feet gas (or 762 thousand barrels oil equivalent) from five horizontal wells in Campbell County in the Powder River Basin to date (which is an average of 152 thousand barrels oil equivalent per well). Current average per well rate is 103 barrels oil per day and 554 thousand cubic feet gas per day (or 248 barrels oil equivalent per day).

Crossbow Joint Venture

Multi-Project Horizontal Well Development Program
Powder River Basin (Core), Campbell County, Wyoming



EAGLE
NATURAL RESOURCES

Crossbow Joint Venture – Low-Risk Horizontal Development

Powder River Basin (Core) – Campbell County, Wyoming

To the south of the Powder River Basin, Eagle Natural Resources has participated in a non-operating working interest position in 83 consecutive successful Niobrara and Codell wells in Colorado to date, including the Rio La, Wilson, Rinn Valley, Groves Farm, Calvary Farms, Riverdale and Tatanka Projects, with gross production of 17.6 Million Barrels Oil, Equivalent, since September 2018, from these seven projects.

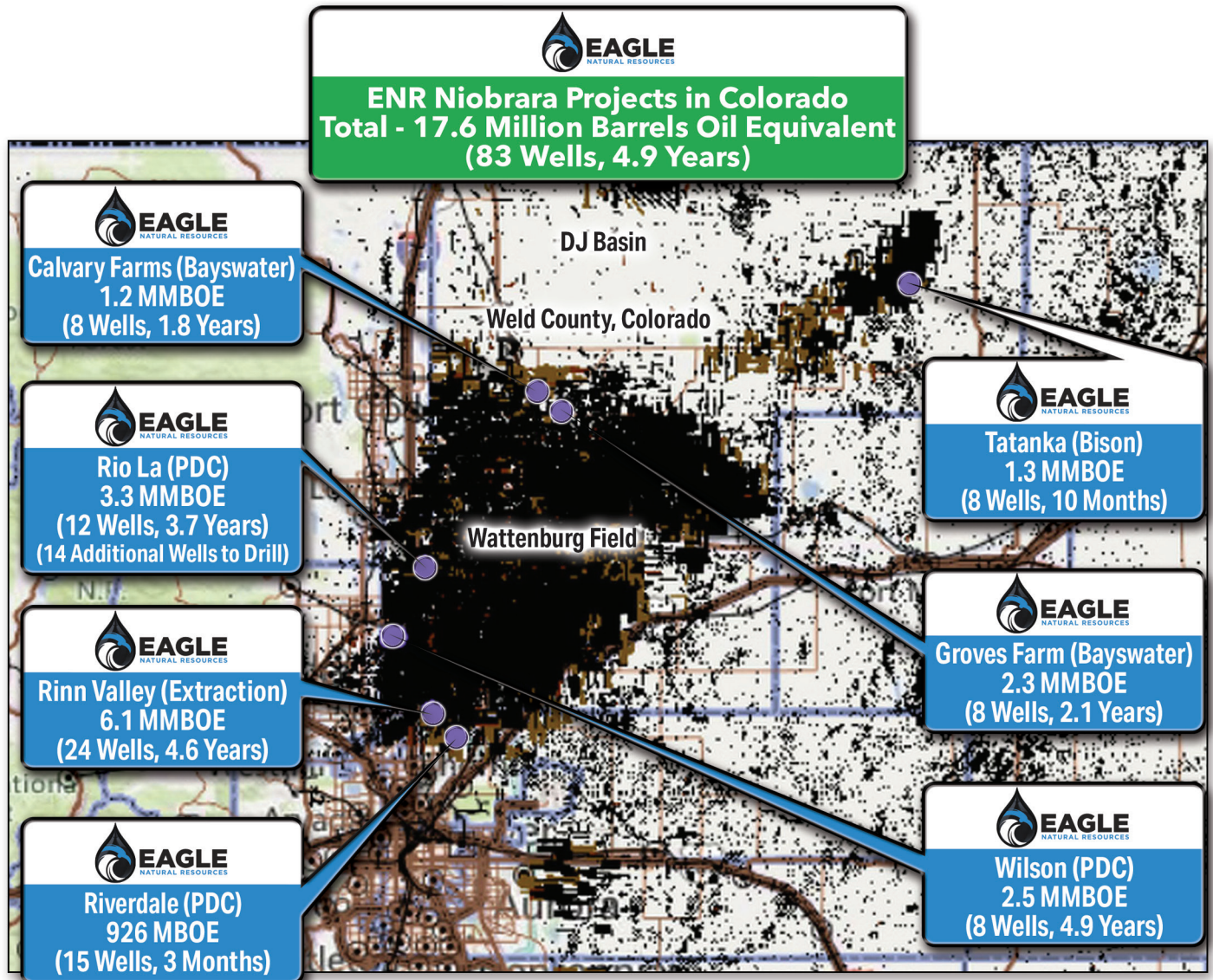

Eagle continues to pursue additional non-operating working interest projects in the Powder River Basin, DJ Basin, and Permian Basin, taking advantage of recovering oil and natural gas prices, as well as the later generation completion techniques developed by industry over many years, receiving the benefit of billions of dollars invested in the “learning curve” of early development in the prolific Niobrara and Frontier formations in the Powder River Basin of Wyoming.

Crossbow Joint Venture

Multi-Project Horizontal Well Development Program
Powder River Basin (Core), Campbell County, Wyoming



EAGLE
NATURAL RESOURCES

Multi-Project Development Program - Powder River Basin (Core), Wyoming 8 New Horizontal Wells - 6 Niobrara Wells and 2 Mowry Wells

Two Projects - Two Leases - Two Operators (EOG Resources and Peak Powder Resources) - 2-Mile Laterals
1.912500% (Avg) Non-Operated Working Interest, 1.434375% (Avg) Net Revenue Interest (in Each Well) - Available for \$3.6MM

Project 1: Operator EOG Resources - Four Niobrara Wells - Four Wells Completed (Pending Production)

Project 2: Operator Peak Powder Resources - Two Niobrara Wells and Two Mowry Wells - Three Wells Completed (Pending Production) and One Well Permitted (to Drill)

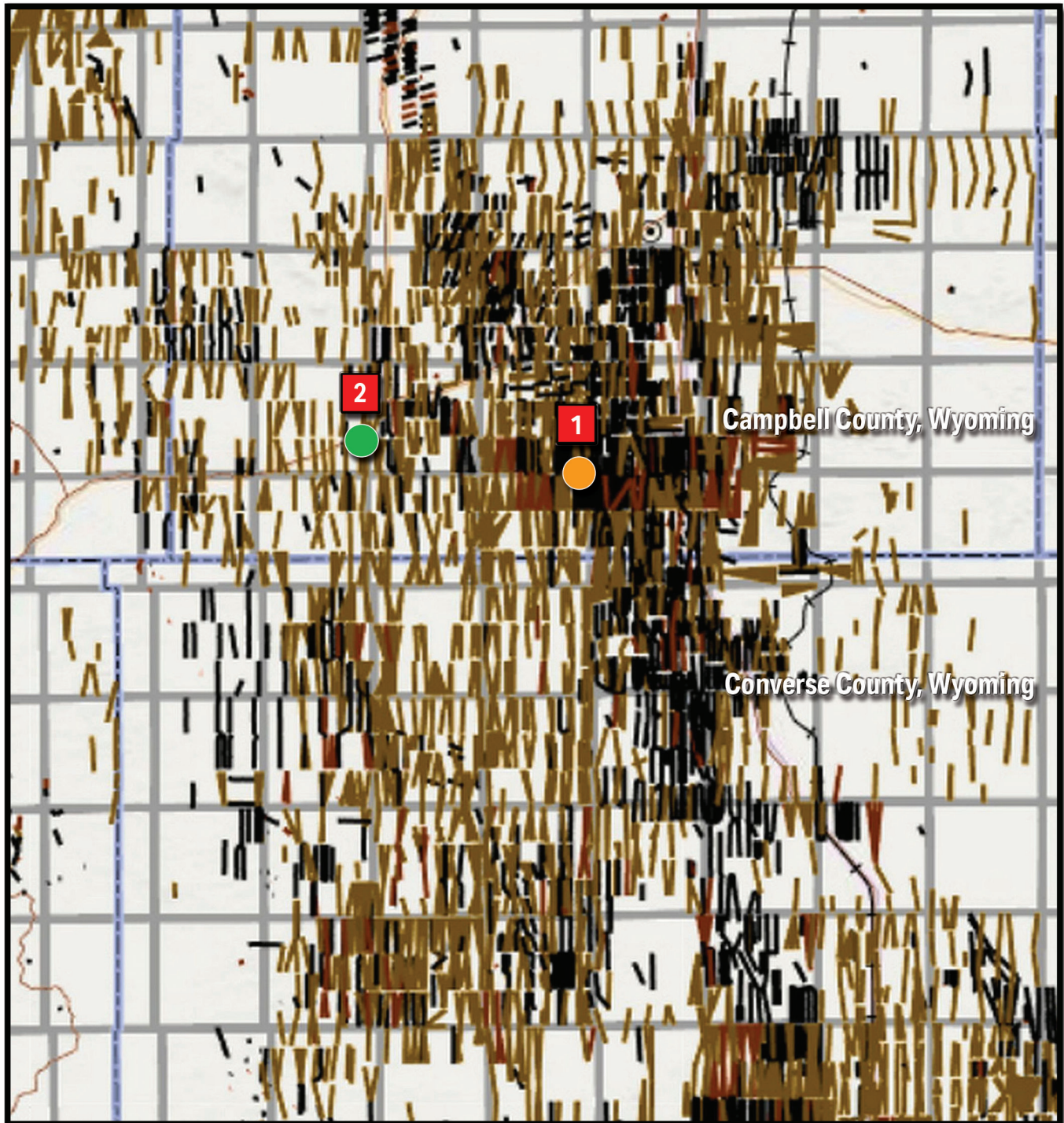

Crossbow Joint Venture

Multi-Project Horizontal Well Development Program
Powder River Basin (Core), Campbell County, Wyoming



EAGLE
NATURAL RESOURCES

PROJECT 1 (Reyes): Four Niobrara Wells - Operator EOG Resources Drilling and Completing
Operational Status as of 4-2-25: Four Wells Completed (Pending Production)

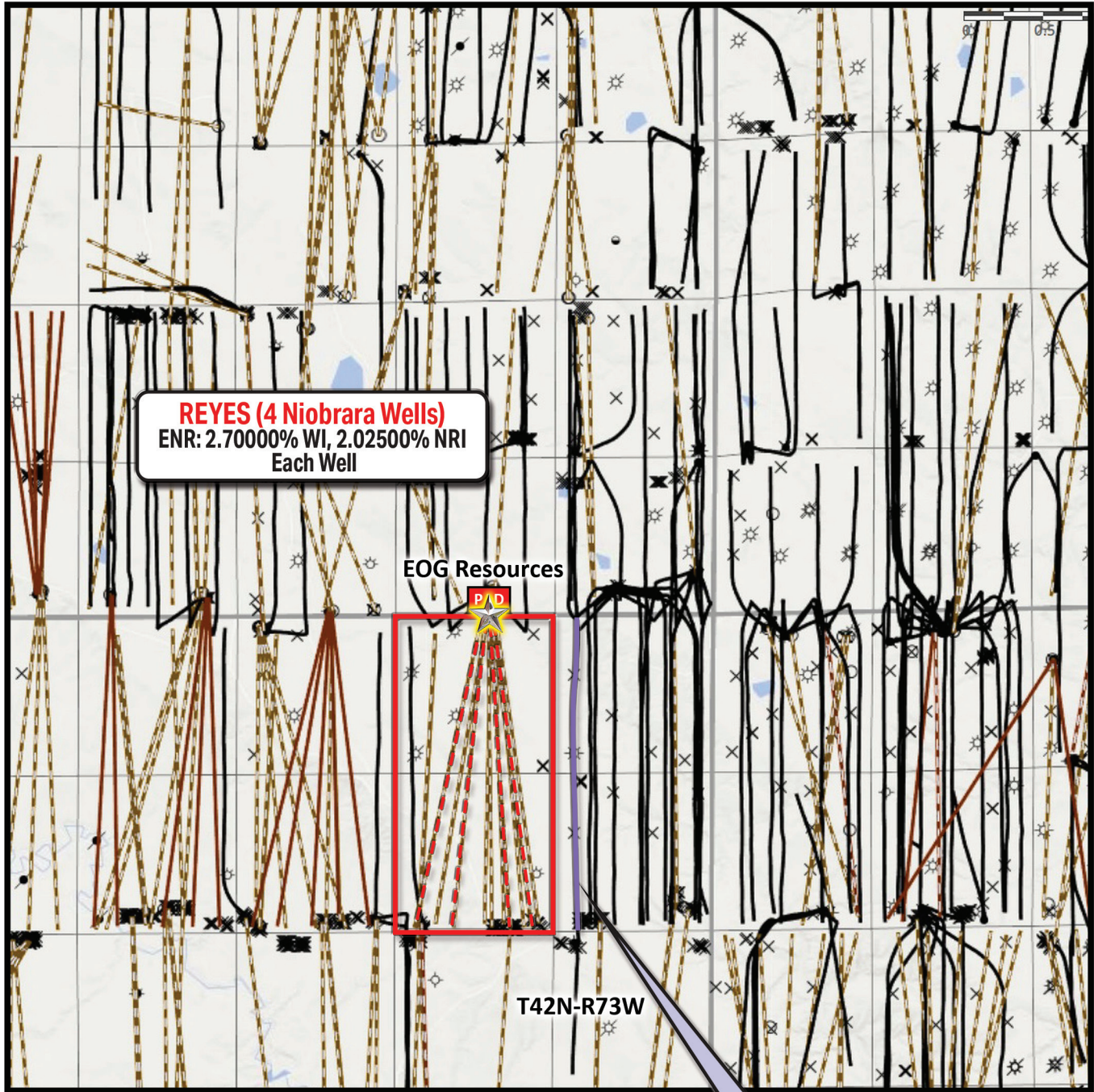

REYES (4 Niobrara Wells)
ENR: 2.70000% WI, 2.02500% NRI
Each Well

EOG Resources

P/D

T42N-R73W

Offset Niobrara Analog Well (2-Mile Lateral) - EOG Resources
374,158 BO + 1,642,468 MCFG (456,281 BOE)
(API 4900561931 - June 2016 to Sept 2024, 8.3 Years)
EUR 522,692 BO + 2,092,553 MCFG (627,319 BOE)
(January 2025 to December 2044, 20 Years, Estimate)

Crossbow Joint Venture

Multi-Project Horizontal Well Development Program
Powder River Basin (Core), Campbell County, Wyoming



EAGLE
NATURAL RESOURCES

PROJECT 2 (Iberlin): Two Niobrara Wells and Two Mowry Wells - Operator Peak Powder Actively Drilling and Completing
Operational Status as of 4-2-25: Three Wells Completed (Pending Production) and One Well Permitted (to Drill in 2025)

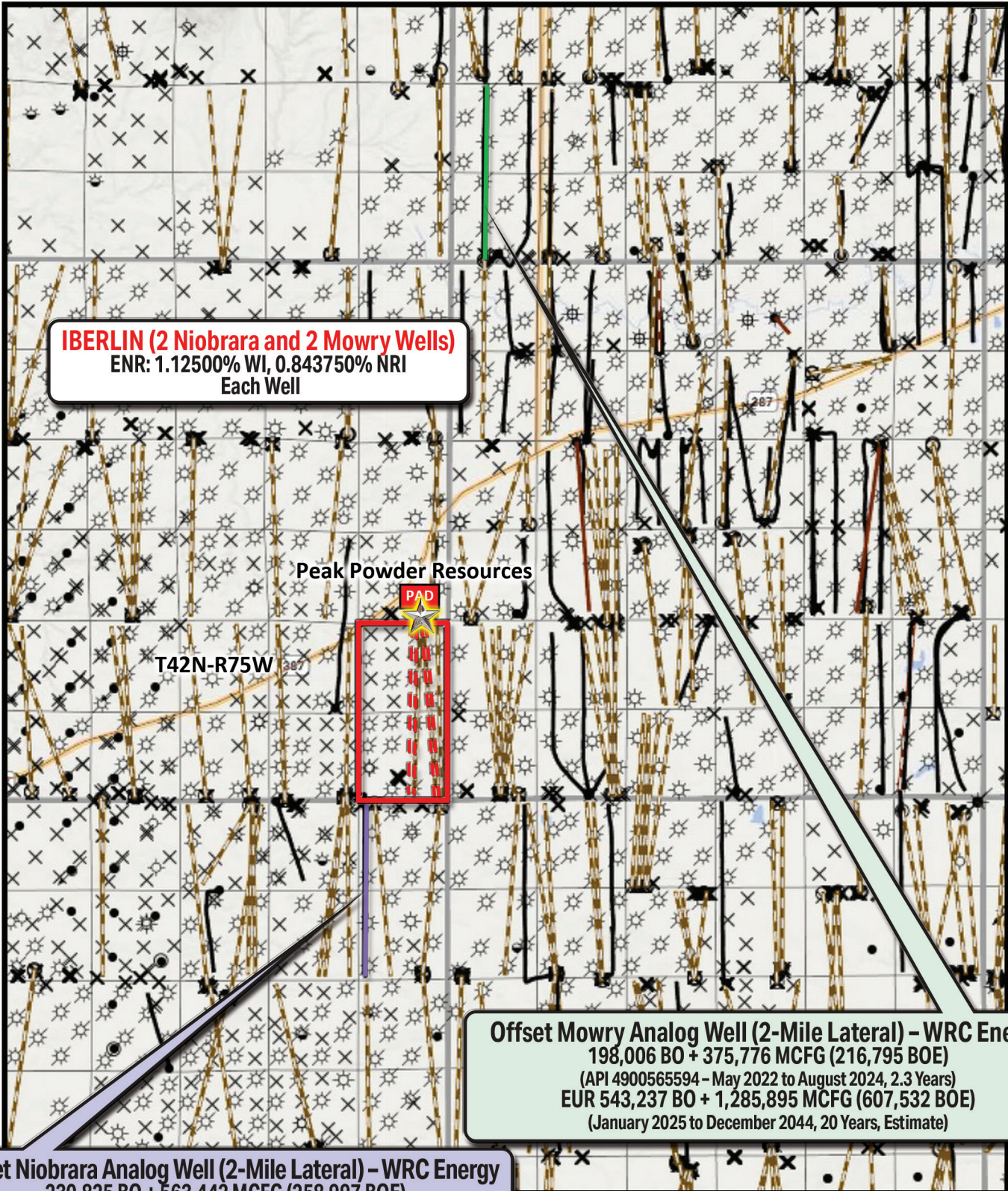

IBERLIN (2 Niobrara and 2 Mowry Wells)
ENR: 1.12500% WI, 0.843750% NRI
Each Well

Peak Powder Resources

T42N-R75W

PAD

Offset Mowry Analog Well (2-Mile Lateral) - WRC Energy
198,006 BO + 375,776 MCFG (216,795 BOE)
(API 4900565594 - May 2022 to August 2024, 2.3 Years)
EUR 543,237 BO + 1,285,895 MCFG (607,532 BOE)
(January 2025 to December 2044, 20 Years, Estimate)

Offset Niobrara Analog Well (2-Mile Lateral) - WRC Energy
230,825 BO + 563,442 MCFG (258,997 BOE)
(API 4900563949 - October 2022 to August 2024, 1.9 Years)
EUR 575,558 BO + 1,628,207 MCFG (656,968 BOE)
(January 2025 to December 2044, 20 Years, Estimate)

Crossbow Joint Venture

Multi-Project Horizontal Well Development Program
Powder River Basin (Core), Campbell County, Wyoming



EAGLE
NATURAL RESOURCES

Crossbow Joint Venture

Powder River Basin, Campbell County, Wyoming

Two Different Non-Op Working Interest Projects

Eight Total Horizontal Wells in Two Different Formations: 6 Niobrara Wells and 2 Mowry Wells

Two Different Operators: EOG Resources (4 Wells) and Peak Powder Resources (4 Wells) - 2-Mile Laterals

Operational Status: 1) Seven Wells Completed (Pending Production) and 2) One Well Permitted (To Drill)

Project	API	Operator	Well	Formation	Status	WI	NRI	County
1	4900577705	EOG Resources	Reyes 0211-05H	Niobrara	Completed, Pending Production 3/25	2.700000%	2.0250000%	Campbell, WY
1	4900577706	EOG Resources	Reyes 0211-06H	Niobrara	Completed, Pending Production 3/25	2.700000%	2.0250000%	Campbell, WY
1	4900577700	EOG Resources	Reyes 0211-08H	Niobrara	Completed, Pending Production 3/25	2.700000%	2.0250000%	Campbell, WY
1	4900577707	EOG Resources	Reyes 0211-07H	Niobrara	Completed, Pending Production 3/25	2.700000%	2.0250000%	Campbell, WY
2	4900578620	Peak Powder Resources	Iberlin 1-25-36MH	Mowry	Permitted 6/24, To Drill in 2025	1.125000%	0.8437500%	Campbell, WY
2	4900578621	Peak Powder Resources	Iberlin 1-25-36NH	Niobrara	Completed, Pending Production 2/25	1.125000%	0.8437500%	Campbell, WY
2	4900578622	Peak Powder Resources	Iberlin 3-25-36MH	Mowry	Completed, Pending Production 2/25	1.125000%	0.8437500%	Campbell, WY
2	4900578623	Peak Powder Resources	Iberlin 3-25-36NH	Niobrara	Completed, Pending Production 2/25	1.125000%	0.8437500%	Campbell, WY

8 Wells Total	15.300000%	11.475000%
	Total WI	Total NRI
	1.912500%	1.434375%
	Avg WI Each Well	Avg NRI Each Well



Crossbow Joint Venture

Multi-Project Horizontal Well Development Program Powder River Basin (Core), Campbell County, Wyoming



EAGLE
NATURAL RESOURCES

Crossbow Joint Venture

8 New Horizontal Wells - 6 Niobrara Wells and 2 Mowry Wells
Powder River Basin (Core) - Campbell County, Wyoming

Monthly Income Conversion Table

Total Acquisition Cost:	\$3,600,000	Drilling:	\$1,800,000.00	Table Based on 1 Unit:	\$100,000
		Completion:	\$1,800,000.00	Individual Tax Rate:	40%
Crossbow (8 Wells):		Units:	36	Drill, Test and Complete - Tax Savings:	\$40,000
Gross Working Interest (Each Well, Avg):	1.912500%			(100% Deduction, 40% Tax Rate)	
Gross Net Revenue Interest (Each Well, Avg):	1.434375%	75% NRI (Gross)		Risk Capital (minus Tax Savings):	\$60,000
Unit Working Interest (Each Well, Avg):	0.053125%	(\$100k/\$3600k)		Total Projections at Risk Capital (after Tax Benefit) for Drill, Test and Completion:	\$60,000
Unit Net Revenue Interest (Each Well, Avg):	0.039844%	(\$100k/\$3600k)			

Project		% of Production
Project 1		
Reyes Niobrara Analog	627,319 BOE EUR	70.6%
Reyes Niobrara Analog Initial Potential Rate	1,963 BOEPD	
Reyes Niobrara Analog Year 1 Avg Rate	513 BOEPD	
Project 2a		
Iberlin Niobrara Analog	656,968 BOE EUR	14.7%
Iberlin Niobrara Analog Initial Potential Rate	2,154 BOEPD	
Iberlin Niobrara Analog Year 1 Avg Rate	559 BOEPD	
Project 2b		
Iberlin Mowry Analog	607,532 BOE EUR	14.7%
Iberlin Mowry Analog Initial Potential Rate	1,253 BOEPD	
Iberlin Mowry Analog Year 1 Avg Rate	423 BOEPD	
NRI-Weighted Hybrid Analog (Each Well)	628,769 BOE EUR	100.0%
	8 Total Wells (Average)	

NRI-Weighted Average Daily BOE Production by Year (Each Well)

Year	Avg BOE Per Day	8 Total Wells (Average)
1	532	
2	207	
3	133	
4	104	
5	92	
6	80	
7	71	
8	64	
9	59	
10	54	

8 Total Wells (Average) for each Project Averaged by NRI (same as EURs) Same Colors are Highlighted on the Tables for Nearest Values

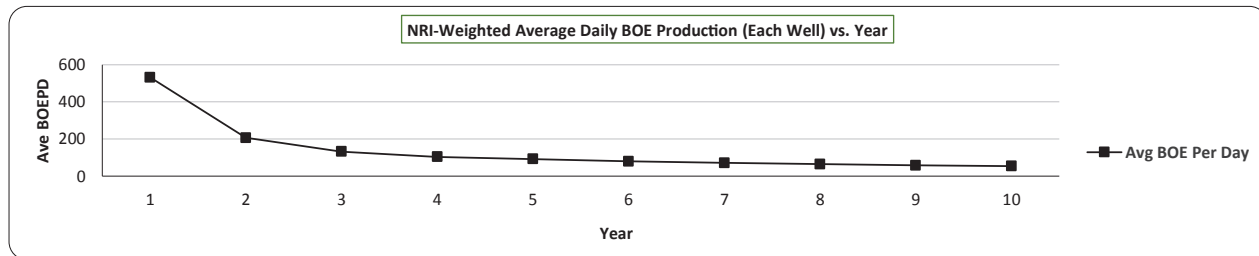

8 WELLS - NET MONTHLY PRODUCTION INCOME POTENTIAL and ANNUAL RETURN

Oil / Price	\$65			\$80			\$95		
	Monthly Production	Annual Return % Cash On Cash	Annual Return % w/ Tax Deduction	Monthly Production	Annual Return % Cash On Cash	Annual Return % w/ Tax Deduction	Monthly Production	Annual Return % Cash On Cash	Annual Return % w/ Tax Deduction
2,200	\$11,993	144%	240%	\$14,760	177%	295%	\$17,528	210%	351%
2,000	\$10,902	131%	218%	\$13,418	161%	268%	\$15,934	191%	319%
1,250	\$6,814	82%	136%	\$8,386	101%	168%	\$9,959	120%	199%
750	\$4,088	49%	82%	\$5,032	60%	101%	\$5,975	72%	120%
600	\$3,271	39%	65%	\$4,025	48%	81%	\$4,780	57%	96%
525	\$2,862	34%	57%	\$3,522	42%	70%	\$4,183	50%	84%
400	\$2,180	26%	44%	\$2,684	32%	54%	\$3,187	38%	64%
200	\$1,090	13%	22%	\$1,342	16%	27%	\$1,593	19%	32%
150	\$818	10%	16%	\$1,006	12%	20%	\$1,195	14%	24%
100	\$545	7%	11%	\$671	8%	13%	\$797	10%	16%
50	\$273	3%	5%	\$335	4%	7%	\$398	5%	8%

Price Ratio BOE Conversion of 20 used as 20-year average ratio (Assumes \$3.25 Natural Gas at \$65 Oil, or price ratio of 20)

\$ and % are for combined interests at certain per well rate and price

8 WELLS - GROSS RETURN POTENTIAL

7.5% Op Costs + 6% Severance Taxes Deducted

Oil / Price	\$65			\$80			\$95		
	Total Production	Cash On Cash Return %	w/ Tax Deduction Return %	Total Production	Cash On Cash Return %	w/ Tax Deduction Return %	Total Production	Cash On Cash Return %	w/ Tax Deduction Return %
1,000,000	\$179,217	179%	299%	\$220,575	221%	368%	\$261,933	262%	437%
850,000	\$152,335	152%	254%	\$187,489	187%	312%	\$222,643	223%	371%
700,000	\$125,452	125%	209%	\$154,403	154%	257%	\$183,353	183%	306%
650,000	\$116,491	116%	194%	\$143,374	143%	239%	\$170,256	170%	284%
625,000	\$112,011	112%	187%	\$137,859	138%	230%	\$163,708	164%	273%
600,000	\$107,530	108%	179%	\$132,345	132%	221%	\$157,160	157%	262%
550,000	\$98,569	99%	164%	\$121,316	121%	202%	\$144,063	144%	240%
400,000	\$71,687	72%	119%	\$88,230	88%	147%	\$104,773	105%	175%
300,000	\$53,765	54%	90%	\$66,173	66%	110%	\$78,580	79%	131%

Price Ratio BOE Conversion of 20 used as 20-year average ratio (Assumes \$3.25 Natural Gas at \$65 Oil, or price ratio of 20)

7.5% Op Costs + 6% Wyoming Severance Taxes Deducted

The values shown are hypothetical and are used to assist in the calculations relating to possible production levels.

See CIM "RISK FACTORS" and "PROPOSED ACTIVITIES". See attached conversion table and economic analysis assumptions.

CONFIDENTIAL and ESTIMATES ONLY

Crossbow Joint Venture

Multi-Project Horizontal Well Development Program Powder River Basin (Core), Campbell County, Wyoming



EAGLE
NATURAL RESOURCES

Crossbow Joint Venture

8 New Horizontal Wells - 6 Niobrara Wells and 2 Mowry Wells
Powder River Basin (Core) - Campbell County, Wyoming

NATURAL GAS UPSIDE CASE - ASSUMES HIGHER NATURAL GAS PRICES AS PREVIOUS TABLE
(Assumes \$6.50 Natural Gas at \$65 Oil, rather than \$3.25 Natural Gas at \$65 Oil)

Monthly Income Conversion Table

Total Acquisition Cost:	\$3,600,000	Drilling:	\$1,800,000.00	Table Based on 1 Unit:	\$100,000
		Completion:	\$1,800,000.00	Individual Tax Rate:	40%
Crossbow (8 Wells):		Units:	36	Drill, Test and Complete - Tax Savings:	\$40,000
Gross Working Interest (Each Well, Avg):	1.912500%			(100% Deduction, 40% Tax Rate)	
Gross Net Revenue Interest (Each Well, Avg):	1.434375%	75% NRI (Gross)		Risk Capital (minus Tax Savings):	\$60,000
Unit Working Interest (Each Well, Avg):	0.053125%	(\$100k/\$3600k)		Total Projections at Risk Capital (after Tax Benefit) for Drill, Test and Completion:	\$60,000
Unit Net Revenue Interest (Each Well, Avg):	0.039844%	(\$100k/\$3600k)			

Project	Analogue	BOE EUR	% of Production
Project 1	Reyes Niobrara Analog	731,947 BOE EUR	70.6%
	Reyes Niobrara Analog Initial Potential Rate	2,177 BOEPPD	
	Reyes Niobrara Analog Year 1 Avg Rate	607 BOEPPD	
Project 2a	Iberlin Niobrara Analog	738,378 BOE EUR	14.7%
	Iberlin Niobrara Analog Initial Potential Rate	2,275 BOEPPD	
	Iberlin Niobrara Analog Year 1 Avg Rate	617 BOEPPD	
Project 2b	Iberlin Mowry Analog	671,827 BOE EUR	14.7%
	Iberlin Mowry Analog Initial Potential Rate	1,301 BOEPPD	
	Iberlin Mowry Analog Year 1 Avg Rate	453 BOEPPD	
NRI-Weighted Hybrid Analog (Each Well)		724,052 BOE EUR	100.0%

8 Total Wells (Average)

NRI-Weighted Average Daily BOE Production by Year (Each Well)

Year	Avg BOE Per Day
1	591
2	234
3	150
4	116
5	104
6	91
7	80
8	72
9	66
10	61

8 Total Wells (Average)
Avg BOE Production for each Project Averaged by NRI (same as EURs)
Same Colors are Highlighted on the Tables for Nearest Values

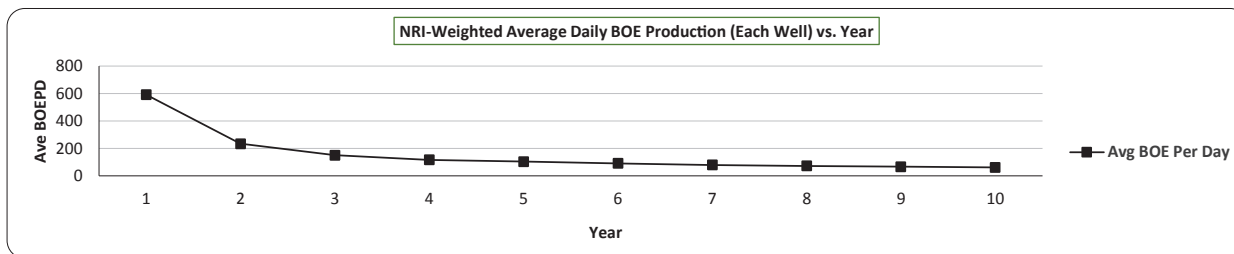

8 WELLS - NET MONTHLY PRODUCTION INCOME POTENTIAL and ANNUAL RETURN

Oil / Price	\$65			\$80			\$95		
	Monthly Production	Annual Return % Cash On Cash	Annual Return % w/ Tax Deduction	Monthly Production	Annual Return % Cash On Cash	Annual Return % w/ Tax Deduction	Monthly Production	Annual Return % Cash On Cash	Annual Return % w/ Tax Deduction
2,300	\$12,538	150%	251%	\$15,431	185%	309%	\$18,324	220%	366%
2,200	\$11,993	144%	240%	\$14,760	177%	295%	\$17,528	210%	351%
1,300	\$7,087	85%	142%	\$8,722	105%	174%	\$10,357	124%	207%
750	\$4,088	49%	82%	\$5,032	60%	101%	\$5,975	72%	120%
700	\$3,816	46%	76%	\$4,696	56%	94%	\$5,577	67%	112%
600	\$3,271	39%	65%	\$4,025	48%	81%	\$4,780	57%	96%
450	\$2,453	29%	49%	\$3,019	36%	60%	\$3,585	43%	72%
250	\$1,363	16%	27%	\$1,677	20%	34%	\$1,992	24%	40%
150	\$818	10%	16%	\$1,006	12%	20%	\$1,195	14%	24%
100	\$545	7%	11%	\$671	8%	13%	\$797	10%	16%
50	\$273	3%	5%	\$335	4%	7%	\$398	5%	8%

Price Ratio BOE Conversion of 10 used as 20-year average ratio (Assumes \$6.50 Natural Gas at \$65 Oil, or price ratio of 10)
\$ and % are for combined interests at certain per well rate and price

8 WELLS - GROSS RETURN POTENTIAL

7.5% Op Costs + 6% Severance Taxes Deducted

Oil / Price	\$65			\$80			\$95		
	Total Production	Cash On Cash Return %	w/ Tax Deduction Return %	Total Production	Cash On Cash Return %	w/ Tax Deduction Return %	Total Production	Cash On Cash Return %	w/ Tax Deduction Return %
1,000,000	\$179,217	179%	299%	\$220,575	221%	368%	\$261,933	262%	437%
900,000	\$161,295	161%	269%	\$198,518	199%	331%	\$235,740	236%	393%
800,000	\$143,374	143%	239%	\$176,460	176%	294%	\$209,546	210%	349%
740,000	\$132,621	133%	221%	\$163,226	163%	272%	\$193,830	194%	323%
725,000	\$129,932	130%	217%	\$159,917	160%	267%	\$189,901	190%	317%
670,000	\$120,076	120%	200%	\$147,785	148%	246%	\$175,495	175%	292%
550,000	\$98,569	99%	164%	\$121,316	121%	202%	\$144,063	144%	240%
400,000	\$71,687	72%	119%	\$88,230	88%	147%	\$104,773	105%	175%
300,000	\$53,765	54%	90%	\$66,173	66%	110%	\$78,580	79%	131%

The values shown are hypothetical and are used to assist in the calculations relating to possible production levels.
7.5% Op Costs + 6% Wyoming Severance Taxes Deducted
See CIM "RISK FACTORS" and "PROPOSED ACTIVITIES". See attached conversion table and economic analysis assumptions.

CONFIDENTIAL and ESTIMATES ONLY

Crossbow Joint Venture

Multi-Project Horizontal Well Development Program
Powder River Basin (Core), Campbell County, Wyoming



EAGLE
NATURAL RESOURCES

S&P

Wed Nov 06, 2024

Detailed Production Report

A051783 (Well)

County, State/Prov: CAMPBELL, WYOMING

Lease: BALLISTA Well Number: 213-1301H

Operator: EOG RESOURCES INC (194766)

Status: ACTIVE

Prod ID: A051783

Production Thru Date: Sep 30, 2024

Project 1 (Reyes) Offset Analog Niobrara Production

Header Block

Data Source:	PI	Country Name:	UNITED STATES
Lease Name:	BALLISTA	Completion Date:	Jun 14, 2016
Operator:	EOG RESOURCES INC	Total Depth:	20,684 FT
State/Prov:	WYOMING	Upper Perforation:	11,053 FT
County:	CAMPBELL	Lower Perforation:	20,592 FT
Primary API/UWI:	49005619310000	Oil Gravity:	28 API
Regulatory/CDN License:		Gas Gravity:	
First Production Date:	Jun 01, 2016	Last Production Date:	Sep 30, 2024
Field:	WC	Temp Gradient:	2.0 FFT
Reservoir/Pool Name:	NIOBRARA	N Factor:	
Prod Zone:	NIOBRARA	Prod Zone Code:	603NBRR
Basin:	POWDER RIVER BASIN (725500)	GOR:	3 CFB
Play Name:	NIOBRARA FRACTURE PLAY	Play Type:	SHALE (SHALE)
Gas Gatherer:	UNKWN	Primary Product:	CRUDE OIL
Liquid Gatherer:	UNKWN	Status:	ACTIVE
Location:	13 41N 73W NW	Data Source:	PI
Latitude/Longitude	+43.53172 -105.58113	Lat/Long Source:	IH
Cum Data Source:	PI		
Cum Oil:	374,158 BBL	Cum Inj Liq:	
Cum Gas:	1,642,468 MCF	Cum Inj Gas:	
Cum Water:	105,020 BBL	Cum Inj Water:	

Annual Production

Data Source:	PI		
(8 years)		Oil BBLs	Gas MCF
Beginning Cum:			Water BBLs
2016		112,931	488,323
2017		82,311	392,879
2018		50,516	233,485
2019		37,822	158,673
2020		28,839	118,502
2021		23,165	78,829
2022		16,449	76,228
2023		13,988	59,899
2024		8,137	35,650
TOTALS		374,158	1,642,468

Monthly Production

Data Source: PI

(Most recent 100 of 100 months)

Year	Month	Oil BBLs	Gas MCF	Water BBLs	GOR SCF/BBLs	% Water	State Well Count	Days On
2016	JUN	25,824	72,188	21,725	2795	45.69	1	26
2016	JUL	22,223	100,457	15,153	4520	40.54	1	31

Crossbow Joint Venture

Multi-Project Horizontal Well Development Program
Powder River Basin (Core), Campbell County, Wyoming



EAGLE
NATURAL RESOURCES

S&P

Wed Nov 06, 2024

Detailed Production Report

Year	Month	Oil BBLs	Gas MCF	Water BBLs	GOR SCF/BBLs	% Water	State Well Count	Days On
2016	AUG	16,989	76,212	5,532	4486	24.56	1	30
2016	SEP	14,010	69,224	4,296	4941	23.47	1	30
2016	OCT	12,784	64,530	3,522	5048	21.60	1	31
2016	NOV	10,657	54,683	2,536	5131	19.22	1	30
2016	DEC	10,444	51,029	2,074	4886	16.57	1	31
Totals 2016		112,931	488,323	54,838				
2017	JAN	9,168	46,214	1,352	5041	12.85	1	28
2017	FEB	8,004	40,019	1,571	5000	16.41	1	28
2017	MAR	8,105	41,233	1,433	5087	15.02	1	31
2017	APR	7,491	36,443	1,188	4865	13.69	1	30
2017	MAY	7,356	32,432	841	4409	10.26	1	29
2017	JUN	6,840	31,724	1,079	4638	13.63	1	30
2017	JUL	6,661	31,103	981	4669	12.84	1	31
2017	AUG	6,361	29,004	847	4560	11.75	1	31
2017	SEP	5,522	24,797	549	4491	9.04	1	26
2017	OCT	6,445	27,689	721	4296	10.06	1	31
2017	NOV	5,122	27,009	897	5273	14.90	1	30
2017	DEC	5,236	25,212	741	4815	12.40	1	31
Totals 2017		82,311	392,879	12,200				
2018	JAN	5,112	22,854	449	4471	8.07	1	31
2018	FEB	4,553	20,453	572	4492	11.16	1	28
2018	MAR	4,875	21,976	618	4508	11.25	1	31
2018	APR	4,564	20,266	580	4440	11.28	1	30
2018	MAY	4,530	20,897	604	4613	11.76	1	31
2018	JUN	4,211	18,787	499	4461	10.59	1	29
2018	JUL	4,259	19,866	640	4664	13.06	1	31
2018	AUG	3,338	15,543	154	4656	4.41	1	19
2018	SEP	2,747	11,505	264	4188	8.77	1	21
2018	OCT	5,116	26,334	999	5147	16.34	1	31
2018	NOV	3,572	18,226	729	5102	16.95	1	30
2018	DEC	3,639	16,778	627	4611	14.70	1	31
Totals 2018		50,516	233,485	6,735				
2019	JAN	3,589	16,307	553	4544	13.35	1	31
2019	FEB	3,189	14,349	468	4500	12.80	1	28
2019	MAR	3,377	15,183	445	4496	11.64	1	31
2019	APR	3,319	14,308	411	4311	11.02	1	30
2019	MAY	2,572	10,215	243	3972	8.63	1	25
2019	JUN	3,874	15,568	271	4019	6.54	1	26
2019	JUL	3,167	12,653	305	3995	8.78	1	31
2019	AUG	3,161	13,932	469	4407	12.92	1	31
2019	SEP	2,980	11,916	341	3999	10.27	1	30
2019	OCT	2,945	11,592	276	3936	8.57	1	31
2019	NOV	2,868	11,473	332	4000	10.38	1	30
2019	DEC	2,781	11,177	300	4019	9.74	1	31
Totals 2019		37,822	158,673	4,414				
2020	JAN	2,821	10,770	241	3818	7.87	1	31
2020	FEB	2,676	11,895	432	4445	13.90	1	29
2020	MAR	2,582	10,831	429	4195	14.25	1	31
2020	APR	2,506	10,365	430	4136	14.65	1	30

Crossbow Joint Venture

Multi-Project Horizontal Well Development Program
Powder River Basin (Core), Campbell County, Wyoming



EAGLE
NATURAL RESOURCES

S&P

Wed Nov 06, 2024

Detailed Production Report

Year	Month	Oil BBLs	Gas MCF	Water BBLs	GOR SCF/BBLs	% Water	State Well Count	Days On
2020	MAY				0			
2020	JUN	2,342	7,700	25	3288	1.06	1	11
2020	JUL	3,510	13,977	108	3982	2.99	1	17
2020	AUG	2,695	12,086	221	4485	7.58	1	31
2020	SEP	2,338	9,296	201	3976	7.92	1	30
2020	OCT	2,757	11,172	351	4052	11.29	1	31
2020	NOV	2,266	10,218	375	4509	14.20	1	30
2020	DEC	2,346	10,192	433	4344	15.58	1	31
Totals 2020		28,839	118,502	3,246				
2021	JAN	2,237	8,644	294	3864	11.62	1	31
2021	FEB	2,110	8,630	325	4090	13.35	1	28
2021	MAR	1,421	6,262	199	4407	12.28	1	20
2021	APR		1				1	1
2021	MAY	5	3		600		1	1
2021	JUN	2,061	2,488	402	1207	16.32	1	9
2021	JUL	3,965	6,336	2,181	1598	35.49	1	19
2021	AUG	3,421	12,356	3,194	3612	48.28	1	31
2021	SEP	2,280	9,290	2,522	4075	52.52	1	30
2021	OCT	2,086	8,569	1,590	4108	43.25	1	31
2021	NOV	1,865	9,224	935	4946	33.39	1	30
2021	DEC	1,714	7,026	865	4099	33.54	1	31
Totals 2021		23,165	78,829	12,507				
2022	JAN	1,693	6,547	739	3867	30.39	1	30
2022	FEB	1,535	5,811	588	3786	27.70	1	25
2022	MAR	1,625	7,115	683	4378	29.59	1	31
2022	APR	1,495	9,368	793	6266	34.66	1	30
2022	MAY	1,416	8,319	665	5875	31.96	1	31
2022	JUN	1,319	7,446	551	5645	29.47	1	30
2022	JUL	1,272	6,444	475	5066	27.19	1	29
2022	AUG	1,381	6,102	450	4419	24.58	1	30
2022	SEP	1,322	5,867	388	4438	22.69	1	30
2022	OCT	1,240	5,003	258	4035	17.22	1	31
2022	NOV	1,323	5,126	300	3875	18.48	1	30
2022	DEC	828	3,080	237	3720	22.25	1	25
Totals 2022		16,449	76,228	6,127				
2023	JAN	1,648	5,640	251	3422	13.22	1	29
2023	FEB	1,208	6,276	428	5195	26.16	1	28
2023	MAR	1,068	4,627	372	4332	25.83	1	31
2023	APR	1,136	4,428	213	3898	15.79	1	29
2023	MAY	1,231	4,882	245	3966	16.60	1	31
2023	JUN	1,080	4,216	230	3904	17.56	1	30
2023	JUL	1,247	4,963	269	3980	17.74	1	31
2023	AUG	1,170	5,205	310	4449	20.95	1	31
2023	SEP	988	4,749	215	4807	17.87	1	30
2023	OCT	1,098	4,362	213	3973	16.25	1	31
2023	NOV	1,012	5,354	308	5291	23.33	1	30
2023	DEC	1,102	5,197	309	4716	21.90	1	31
Totals 2023		13,988	59,899	3,363				
2024	JAN	922	4,262	195	4623	17.46	1	22

Crossbow Joint Venture

Multi-Project Horizontal Well Development Program
Powder River Basin (Core), Campbell County, Wyoming



EAGLE
NATURAL RESOURCES

S&P

Detailed Production Report

Wed Nov 06, 2024

Year	Month	Oil BBLs	Gas MCF	Water BBLs	GOR SCF/BBLs	% Water	State Well Count	Days On
2024	FEB	927	5,110	283	5512	23.39	1	29
2024	MAR	915	4,422	223	4833	19.60	1	31
2024	APR	775	2,975	83	3839	9.67	1	30
2024	MAY	564	1,642	58	2911	9.32	1	21
2024	JUN	1,337	5,472	192	4093	12.56	1	30
2024	JUL	925	4,148	192	4484	17.19	1	31
2024	AUG	934	3,980	197	4261	17.42	1	31
2024	SEP	838	3,639	167	4342	16.62	1	30
Totals 2024		8,137	35,650	1,590				

Oil Tests

API Number	Well Nbr	Data Source	Test Type	Comp Date	Upper Perf.	Lower Perf.	Total Depth	Test Date	WHFP	Choke 64ths	GOR CFBBL	BS + Wtr%	Water B/D	Oil B/D	CsHd Gas Mcfd
49005619310000	213-1301 H	PI	IP	2016-06-14	11053	20592	20684	2016-06-16		31.0	3		1217	1748	4291

Crossbow Joint Venture

Multi-Project Horizontal Well Development Program
Powder River Basin (Core), Campbell County, Wyoming



EAGLE
NATURAL RESOURCES

S&P

Wed Nov 06, 2024

Detailed Production Report

A084602 (Well)

County, State/Prov: CAMPBELL, WYOMING
Lease: ANCHO W Well Number: 4175-1-12-1NH
Operator: WRC ENERGY LLC (349104)
Status: ACTIVE
Prod ID: A084602
Production Thru Date: Sep 30, 2024

Project 2 (Iberlin) Offset Analog Niobrara Production

Header Block

Data Source:	PI	Country Name:	UNITED STATES
Lease Name:	ANCHO W	Completion Date:	Sep 02, 2022
Operator:	WRC ENERGY LLC	Total Depth:	22,374 FT
State/Prov:	WYOMING	Upper Perforation:	
County:	CAMPBELL	Lower Perforation:	0 FT
Primary API/UWI:	49005639490000	Oil Gravity:	
Regulatory/CDN License:		Gas Gravity:	
First Production Date:	Oct 01, 2022	Last Production Date:	Sep 30, 2024
Field:	WC	Temp Gradient:	2.0 FFT
Reservoir/Pool Name:	NIOBRARA	N Factor:	
Prod Zone:	NIOBRARA	Prod Zone Code:	603NBRR
Basin:	POWDER RIVER BASIN (725500)	GOR:	
Play Name:	NIOBRARA FRACTURE PLAY	Play Type:	SHALE (SHALE)
Gas Gatherer:	UNKWN	Primary Product:	CRUDE OIL
Liquid Gatherer:	UNKWN	Status:	ACTIVE
Location:	35 42N 75W SE	Data Source:	PI
Latitude/Longitude	+43.56203 -105.82791	Lat/Long Source:	IH
Cum Data Source:	PI		
Cum Oil:	230,825 BBL	Cum Inj Liq:	
Cum Gas:	563,442 MCF	Cum Inj Gas:	
Cum Water:	111,997 BBL	Cum Inj Water:	

Annual Production

Data Source:	PI		
(2 years)		Oil BBLS	Gas MCF
Beginning Cum:			Water BBLS
2022		77,019	140,790
2023		110,212	305,257
2024		43,594	117,395
TOTALS		230,825	563,442
			111,997

Monthly Production

Data Source: PI
(Most recent 23 of 23 months)

Year	Month	Oil BBLS	Gas MCF	Water BBLS	GOR SCF/BBLS	% Water	State Well Count	Days On
2022	OCT	30,602	41,374	19,024	1352	38.33	1	22
2022	NOV	28,734	57,578	28,867	2004	50.12	1	30
2022	DEC	17,683	41,838	11,189	2366	38.75	1	29
Totals 2022		77,019	140,790	59,080				
2023	JAN	13,172	36,483	7,495	2770	36.27	1	26
2023	FEB	13,722	30,894	4,546	2251	24.89	1	28
2023	MAR	11,505	37,145	6,474	3229	36.01	1	31

Crossbow Joint Venture

Multi-Project Horizontal Well Development Program
Powder River Basin (Core), Campbell County, Wyoming



EAGLE
NATURAL RESOURCES

S&P

Wed Nov 06, 2024

Detailed Production Report

Year	Month	Oil BBLs	Gas MCF	Water BBLs	GOR SCF/BBLs	% Water	State Well Count	Days On
2023	APR	10,027	31,647	4,839	3156	32.55	1	30
2023	MAY	9,603	28,537	3,784	2972	28.27	1	30
2023	JUN	8,590	24,879	3,244	2896	27.41	1	30
2023	JUL	8,282	21,700	2,781	2620	25.14	1	31
2023	AUG	7,841	20,756	2,381	2647	23.29	1	31
2023	SEP	7,243	18,725	2,082	2585	22.33	1	30
2023	OCT	7,158	18,789	1,988	2625	21.74	1	31
2023	NOV	6,564	17,988	2,012	2740	23.46	1	30
2023	DEC	6,505	17,714	1,627	2723	20.01	1	31
Totals 2023		110,212	305,257	43,253				
2024	JAN	6,224	16,891	1,489	2714	19.31	1	31
2024	FEB	5,603	15,668	1,323	2796	19.10	1	29
2024	MAR	5,776	15,758	1,259	2728	17.90	1	31
2024	APR	5,556	14,932	1,211	2688	17.90	1	30
2024	MAY	5,410	14,463	1,161	2673	17.67	1	31
2024	JUN	5,066	13,424	1,105	2650	17.91	1	30
2024	JUL	5,048	12,740	1,048	2524	17.19	1	31
2024	AUG	4,911	13,519	1,068	2753	17.86	1	31
Totals 2024		43,594	117,395	9,664				

Oil Tests

Crossbow Joint Venture

Multi-Project Horizontal Well Development Program
Powder River Basin (Core), Campbell County, Wyoming



EAGLE
NATURAL RESOURCES

S&P

Wed Nov 06, 2024

Detailed Production Report

A083846 (Well)

County, State/Prov: CAMPBELL, WYOMING
Lease: IBERLIN FED Well Number: 1-31-30MH
Operator: PEAK PWDR RIVR RESCS (241885)
Status: ACTIVE
Prod ID: A083846
Production Thru Date: Aug 31, 2024

Project 2 (Iberlin) Offset Analog Mowry Production

Header Block

Data Source:	PI	Country Name:	UNITED STATES
Lease Name:	IBERLIN FED	Completion Date:	May 22, 2022
Operator:	PEAK POWDER RIVER RESOURCES LLC	Total Depth:	22,964 FT
State/Prov:	WYOMING	Upper Perforation:	
County:	CAMPBELL	Lower Perforation:	
Primary API/UWI:	49005655940000	Oil Gravity:	
Regulatory/CDN License:		Gas Gravity:	
First Production Date:	May 01, 2022	Last Production Date:	Aug 31, 2024
Field:	WC	Temp Gradient:	2.0 FFT
Reservoir/Pool Name:	MOWRY	N Factor:	
Prod Zone:	MOWRY	Prod Zone Code:	602MWRY
Basin:	POWDER RIVER BASIN (725500)	GOR:	
Play Name:	MOWRY SHALE	Play Type:	SHALE (SHALE)
Gas Gatherer:	UNKWN	Primary Product:	CRUDE OIL
Liquid Gatherer:	UNKWN	Status:	ACTIVE
Location:	31 43N 74W SE	Data Source:	PI
Latitude/Longitude	+43.64994 -105.79392	Lat/Long Source:	IH
Cum Data Source:	PI	Cum Inj Liq:	
Cum Oil:	198,006 BBL	Cum Inj Gas:	
Cum Gas:	375,776 MCF	Cum Inj Water:	
Cum Water:	309,769 BBL		

Annual Production

Data Source:	PI		
(2 years)		Oil BBLs	Gas MCF
Beginning Cum:			Water BBLs
2022		108,066	152,030
2023		62,934	152,845
2024		27,006	70,901
TOTALS		198,006	375,776

Monthly Production

Data Source: PI
(Most recent 28 of 28 months)

Year	Month	Oil BBLs	Gas MCF	Water BBLs	GOR SCF/BBLs	% Water	State Well Count	Days On
2022	MAY	8,248	7,470	35,857	906	81.30	1	31
2022	JUN	24,495	24,757	42,397	1011	63.38	1	30
2022	JUL	19,432	23,826	29,948	1226	60.65	1	31
2022	AUG	14,901	20,013	23,027	1343	60.71	1	31
2022	SEP	11,834	17,814	18,399	1505	60.86	1	30
2022	OCT	11,665	20,635	19,068	1769	62.04	1	31
2022	NOV	9,436	21,251	15,540	2252	62.22	1	30
2022	DEC	8,055	16,264	11,826	2019	59.48	1	31

Crossbow Joint Venture

Multi-Project Horizontal Well Development Program
Powder River Basin (Core), Campbell County, Wyoming



EAGLE
NATURAL RESOURCES

S&P

Wed Nov 06, 2024

Detailed Production Report

Year	Month	Oil BBLs	Gas MCF	Water BBLs	GOR SCF/BBLs	% Water	State Well Count	Days On
Totals 2022		108,066	152,030	196,062				
2023	JAN	7,657	18,032	10,784	2355	58.48	1	31
2023	FEB	6,083	13,403	8,006	2203	56.82	1	28
2023	MAR	6,553	17,299	9,717	2640	59.72	1	31
2023	APR	5,744	15,199	7,989	2646	58.17	1	30
2023	MAY	5,592	15,022	7,408	2686	56.98	1	31
2023	JUN	5,115	13,729	6,436	2684	55.72	1	30
2023	JUL	4,339	9,791	4,728	2257	52.15	1	29
2023	AUG	5,091	11,789	6,099	2316	54.50	1	31
2023	SEP	4,388	10,592	4,902	2414	52.77	1	30
2023	OCT	4,304	9,628	4,363	2237	50.34	1	31
2023	NOV	3,887	8,375	5,248	2155	57.45	1	28
2023	DEC	4,181	9,986	6,787	2388	61.88	1	31
Totals 2023		62,934	152,845	82,467				
2024	JAN	3,893	10,172	5,683	2613	59.35	1	31
2024	FEB	3,478	9,409	3,808	2705	52.26	1	29
2024	MAR	3,636	10,066	3,972	2768	52.21	1	31
2024	APR	3,378	9,100	3,588	2694	51.51	1	30
2024	MAY	3,237	8,534	3,495	2636	51.92	1	31
2024	JUN	3,149	8,462	3,559	2687	53.06	1	30
2024	JUL	3,137	7,703	3,626	2456	53.62	1	31
2024	AUG	3,098	7,455	3,509	2406	53.11	1	31
Totals 2024		27,006	70,901	31,240				

Oil Tests

Crossbow Joint Venture

Multi-Project Horizontal Well Development Program
Powder River Basin (Core), Campbell County, Wyoming



EAGLE
NATURAL RESOURCES

S&P

Wed Apr 02, 2025

Scout Ticket

49005777000000

Project 1 (Reyes) Scout Tickets (4 Niobrara Wells)

General Information

0211-08H REYES

Data Source:	PI	Country:	UNITED STATES
API/UWI:	49005777000000	IC:	
State/Prov:	WYOMING	County:	CAMPBELL
Field:	CROSSBOW	Operator:	EOG RESOURCES INC
Current Status:		Current Operator:	EOG RESOURCES INC
Reg. Well Status/Date:		Final Well Class:	()
Initial Class:	WILDCAT OUTPOST (WO)	Target Objective:	OIL
Final Status:	TREATD	Hole Direction:	HORIZONTAL
Permit:	on Aug 27, 2021 APPROVED	Abandonment Date:	
First Report Date:	Apr 06, 2021	Projected Formation:	NIOBRARA
Projected TD:	21,268 FT	Formation at TD:	NIOBRARA
Basin:	POWDER RIVER BASIN	PRODFit Form at TD:	
Play Name:	NIOBRARA FRACTURE PLAY	Play Type:	{G} (G)

Location

Section, Twp., Range:	35 42N 73W	Data Source:	PI
Spot Code:	SE		
Footage NS EW Origin:	651 FSL 2229 FEL CONGRESS SECTION		
Principal Meridian:	6TH PRINCIPAL MRDN		
Surface Co-ord:	+387240.37 FT +1055959.27 FT	Data Source:	PI
Lat/Long:	+43.5637256 -105.5920852	Lat/Long Source:	IH
PBH L/L:	+43.5333649 -105.5866639	Lat/Long Source:	IH
PBHL Footage NS EW Origin:	200 FSL 750 FEL CONGRESS SECTION	Datum:	NAD27
PBHL Section:	11 41N 73W	Datum:	NAD27
PBHL Coordinates:	From Surface: 21,268 FT	Data Source:	PI
Polar:	Offset:	Spot:	SE
Coordinate:	Y Offset: 11,066 FT S	Data Source:	PI
PBHL Coordinates:	From Surface: 21,268 FT	TVD:	10,391 FT
Polar:	Offset:	Azimuth:	
Coordinate:	Y Offset: N	X Offset:	1,437 FT E
		TVD:	10,391 FT
		Data Source:	PI
		X Offset:	E

Location Narrative

Data Source	Type	Remark
PI	SCALED_FOOT	REGULATORY
PI	IRREG_SECT	Y
PI	DST_FIELD	0.60 MI SW CROSSBOW FLD (FORT UNION)
PI	DST_TOWN	12.97 MI S WRIGHT, WY
PI	LOCATION	SPOTTED WITH PLAT PROPOSED LAT/LONG

Dates and Depths

Data Source:	PI	Spud Date Code:	E
Spud:	Dec 18, 2024	TD Date:	Dec 30, 2024
TD:		PlugBack Depth:	
TVD:		Formation Name TD:	NIOBRARA
Formation Code TD:	603NBRR	PRODFit Form Name TD:	
PRODFit Form Code TD:		KB. Elevation:	5,029 FT
Ref. Elevation:	5,029 FT KB	LTD:	
Ground Elevation:	4,999 FT GR		

Crossbow Joint Venture

Multi-Project Horizontal Well Development Program
Powder River Basin (Core), Campbell County, Wyoming



EAGLE
NATURAL RESOURCES

S&P

Wed Apr 02, 2025

Scout Ticket

Contractor: ENSIGN UNITED STATES DRILLING
 Completed: Final Drilling: Dec 30, 2024
 Rig Release Date: Rig #: 147
 Tool: ROTARY

Production Tests

PT: 001

Data Source:	PI	Top Formation Code:	
Top Formation Name:		PRODFit Top Formation Code:	
PRODFit Top Formation Name:		Base Formation Code:	
Base Formation Name:		PRODFit Base Formation Code:	
PRODFit Base Formation Name:		Condensate:	
Oil:		Water:	
Gas:		Method:	
Interval:	-	Choke:	
Duration of Test:	Hours	GOR:	
Oil Gravity:		Cond Ratio:	
Cond Gravity:		Main Fluid Code:	
Prod Method:			
Remarks on PT Test:	Data Source: PI		

Casing, Liner, Tubing

Narrative	Data Source	Type	Remark
	PI	CASING	SET SURF CSG
	PI	CASING	PROD CSG NOT RPTD

Drilling Journal

Narrative

Narrative	Data Source	Date	Remark
1	PI	Dec 06, 2022	STATE PAPERWORKSURF FTG CHGD FROM 951 FSL 2163 FEL, PBHL FTG CHGD FROM 330 FSL 390 FEL, PROJ DEPTH/FM CHGD FROM 21208 MD 10391 TVD/NIOBRARA
2	PI	Aug 06, 2024	STATE PAPERWORK INITIAL HOLE SPUD 8-4-2024 BY WYOMING CASING SERVICE #1, WORTI
3	PI	Dec 19, 2024	DRLG
4	PI	Dec 23, 2024	SKID RIG TO REYES #0211-06H; PAUSED
5	PI	Dec 30, 2024	RESUMED OPERATIONS APPROX. 12/30/2024; DRLG
6	PI	Jan 02, 2025	STATE PAPERWORKWOCTI
7	PI	Mar 24, 2025	FRAC 21-MAR-25

Dwights Energydata Narrative

Accumulated through 1997

Horizontal

Lateral Hole:	Data Source: PI	Contractor:
	Horizontal Length:	Feet in Pay:
	Formation:	
PRODFit Formation at 80 Degree Heel Point:		Method:
Total Horizontal Displacement:		
Max Build-up rate: /		
Max angle of Deviation:		

Crossbow Joint Venture

Multi-Project Horizontal Well Development Program
Powder River Basin (Core), Campbell County, Wyoming



EAGLE
NATURAL RESOURCES

S&P

Wed Apr 02, 2025

Scout Ticket

49005777070000

General Information

0211-07H REYES

Data Source:	PI	Country:	UNITED STATES
API/UWI:	49005777070000	IC:	
State/Prov:	WYOMING	County:	CAMPBELL
Field:	UNNAMED	Operator:	EOG RESOURCES INC
Current Status:		Current Operator:	EOG RESOURCES INC
Reg. Well Status/Date:		Final Well Class:	()
Initial Class:	DEVELOPMENT WELL (D)	Target Objective:	OIL
Final Status:	TREATD	Hole Direction:	HORIZONTAL
Permit:	on Aug 27, 2021 APPROVED	Abandonment Date:	
First Report Date:	Apr 07, 2021	Projected Formation:	NIOBRARA
Projected TD:	21,130 FT	Formation at TD:	NIOBRARA
Basin:	POWDER RIVER BASIN	PRODFit Form at TD:	
Play Name:	NIOBRARA FRACTURE PLAY	Play Type:	{G} (G)

Location

Section, Twp., Range:	35 42N 73W	Data Source:	PI
Spot Code:	SE		
Footage NS EW Origin:	651 FSL 2254 FEL CONGRESS SECTION		
Principal Meridian:	6TH PRINCIPAL MRDN		
Surface Co-ord:	+387215.37 FT +1055959.27 FT	Data Source:	PI
Lat/Long:	+43.5637256 -105.5921795	Datum:	NAD27
PBH L/L:	+43.5333562 -105.5916415	Lat/Long Source:	IH
PBHL Footage NS EW Origin:	200 FSL 2070 FEL CONGRESS SECTION	Lat/Long Source:	IH
PBHL Section:	11 41N 73W	Data Source:	PI
PBHL Coordinates:	From Surface: 21,130 FT	Spot:	SE
Polar:	Offset:	Data Source:	PI
Coordinate:	Y Offset: 11,069 FT S	TVD:	10,391 FT
PBHL Coordinates:	From Surface: 21,130 FT	Azimuth:	
Polar:	Offset:	X Offset:	142 FT E
Coordinate:	Y Offset: N	TVD:	10,391 FT
		Azimuth:	
		X Offset:	E

Location Narrative

Data Source	Type	Remark
PI	SCALED_FOOT	REGULATORY
PI	IRREG_SECT	Y
PI	LOCATION	SPOTTED WITH SUNDRY/REPORT LAT/LONG
PI	CONG_LOT	CONGRESS LOT

Dates and Depths

Data Source:	PI	Spud Date Code:	A
Spud:	Dec 16, 2024	TD Date:	Dec 26, 2024
TD:		PlugBack Depth:	
TVD:		Formation Name TD:	NIOBRARA
Formation Code TD:	603NBRR	PRODFit Form Name TD:	
PRODFit Form Code TD:		KB. Elevation:	5,029 FT
Ref. Elevation:	5,029 FT KB	LTD:	
Ground Elevation:	4,993 FT GR		
Contractor:	ENSIGN UNITED STATES DRILLING		

Crossbow Joint Venture

Multi-Project Horizontal Well Development Program
Powder River Basin (Core), Campbell County, Wyoming



EAGLE
NATURAL RESOURCES

S&P

Wed Apr 02, 2025

Scout Ticket

Completed: Final Drilling: Dec 26, 2024
Rig Release Date: Rig #: 147
Tool: ROTARY

Production Tests

PT: 001

Data Source:	PI	Top Formation Code:	
Top Formation Name:		PRODFit Top Formation Code:	
PRODFit Top Formation Name:		Base Formation Code:	
Base Formation Name:		PRODFit Base Formation Code:	
Oil:		Condensate:	
Gas:		Water:	
Interval:	-	Method:	
Duration of Test:	Hours	Choke:	
Oil Gravity:		GOR:	
Cond Gravity:		Cond Ratio:	
Prod Method:		Main Fluid Code:	
Remarks on PT Test:	Data Source: PI		

Casing, Liner, Tubing

Narrative	Data Source	Type	Remark
	PI	CASING	SET SURF CSG
	PI	CASING	PROD CSG NOT RPTD

Drilling Journal

Narrative

Narrative	Data Source	Date	Remark
1	PI	Feb 18, 2024	STATE PAPERWORKREPERMITTED 2/15/2024
2	PI	Apr 29, 2024	STATE PAPERWORKSURF FTG CHGD FROM 651 FSL 2201 FEL, PBHL FTG CHGD FROM 200 FSL 1250 FEL, PROJ DEPTH CHGD FROM 21187 MDI
3	PI	Aug 06, 2024	STATE PAPERWORK INITIAL HOLE SPUD 8-3-2024 BY WYOMING CASING SERVICE #1, WORTI
4	PI	Dec 18, 2024	SKID RIG TO REYES #0211-08H; PAUSED
5	PI	Dec 27, 2024	RESUMED OPERATIONS APPROX. 12/27/2024; DRLG
6	PI	Dec 30, 2024	SKID RIG TO REYES #0211-08H; PAUSED
7	PI	Jan 02, 2025	STATE PAPERWORKWOCTI
8	PI	Mar 24, 2025	FRAC 21-MAR-25

Drilling Remark

Drilling Remark	Data Source	Date	Remark
1	PI	Feb 18, 2024	REPERMITTED 2/15/2024
3	PI	Aug 06, 2024	INITIAL HOLE SPUD 8-3-2024 BY WYOMING CASING SERVICE #1

Dwights Energydata Narrative

Accumulated through 1997

Horizontal

Lateral Hole:	Data Source: PI	Contractor:
	Horizontal Length:	Feet in Pay:
	Formation:	

Crossbow Joint Venture

Multi-Project Horizontal Well Development Program
Powder River Basin (Core), Campbell County, Wyoming



EAGLE
NATURAL RESOURCES

S&P

Wed Apr 02, 2025

Scout Ticket

49005777060000

General Information

0211-06H REYES

Data Source:	PI	Country:	UNITED STATES
API/UWI:	49005777060000	IC:	
State/Prov:	WYOMING	County:	CAMPBELL
Field:	UNNAMED	Operator:	EOG RESOURCES INC
Current Status:		Current Operator:	EOG RESOURCES INC
Reg. Well Status/Date:		Final Well Class:	()
Initial Class:	DEVELOPMENT WELL (D)	Target Objective:	OIL
Final Status:	TREATD	Hole Direction:	HORIZONTAL
Permit:	on Apr 01, 2021 APPROVED	Abandonment Date:	
First Report Date:	Apr 07, 2021	Projected Formation:	NIOBRARA
Projected TD:	21,196 FT	Formation at TD:	NIOBRARA
Basin:	POWDER RIVER BASIN	PRODFit Form at TD:	
Play Name:	NIOBRARA FRACTURE PLAY	Play Type:	{G} (G)

Location

Section, Twp., Range:	35 42N 73W	Data Source:	PI
Spot Code:	SE		
Footage NS EW Origin:	651 FSL 2279 FEL CONGRESS SECTION		
Principal Meridian:	6TH PRINCIPAL MRDN		
Surface Co-ord:	+387190.3 FT +1055959.31 FT	Data Source:	PI
Lat/Long:	+43.5637249 -105.5922738	Datum:	NAD27
PBH L/L:	+43.5333474 -105.5964954	Lat/Long Source:	IH
PBHL Footage NS EW Origin:	200 FSL 2000 FWL CONGRESS SECTION	Lat/Long Source:	IH
PBHL Section:	11 41N 73W	Data Source:	PI
PBHL Coordinates:	From Surface: 21,196 FT	Spot:	SW
Polar:	Offset:	Data Source:	PI
Coordinate:	Y Offset: N	TVD:	10,391 FT
PBHL Coordinates:	From Surface: 21,196 FT	Azimuth:	
Polar:	Offset:	X Offset:	E
Coordinate:	Y Offset: 11,072 FT S	TVD:	10,391 FT
		Azimuth:	
		X Offset:	1,119 FT W

Location Narrative

Data Source	Type	Remark
PI	SCALED_FOOT	REGULATORY
PI	IRREG_SECT	Y
PI	CONG_LOT	CONGRESS LOT
PI	LOCATION	SPOTTED WITH SUNDRY/REPORT LAT/LONG

Dates and Depths

Data Source:	PI	Spud Date Code:	E
Spud:	Dec 16, 2024	TD Date:	Dec 30, 2024
TD:		PlugBack Depth:	
TVD:		Formation Name TD:	NIOBRARA
Formation Code TD:	603NBRR	PRODFit Form Name TD:	
PRODFit Form Code TD:		KB. Elevation:	5,029 FT
Ref. Elevation:	5,029 FT KB	LTD:	
Ground Elevation:	4,993 FT GR		
Contractor:	ENSIGN UNITED STATES DRILLING		

Crossbow Joint Venture

Multi-Project Horizontal Well Development Program
Powder River Basin (Core), Campbell County, Wyoming



EAGLE
NATURAL RESOURCES

S&P

Wed Apr 02, 2025

Scout Ticket

Completed: Final Drilling: Dec 30, 2024
Rig Release Date: Rig #: 147
Tool: ROTARY

Production Tests

PT: 001

Data Source: PI	Top Formation Code:
Top Formation Name:	PRODFit Top Formation Code:
PRODFit Top Formation Name:	Base Formation Code:
Base Formation Name:	PRODFit Base Formation Code:
PRODFit Base Formation Name:	Condensate:
Oil:	Water:
Gas:	Method:
Interval: -	Choke:
Duration of Test: Hours	GOR:
Oil Gravity:	Cond Ratio:
Cond Gravity:	Main Fluid Code:
Prod Method:	

Remarks on PT Test: Data Source: PI

Casing, Liner, Tubing

Narrative	Data Source	Type	Remark
	PI	CASING	SET SURF CSG
	PI	CASING	PROD CSG NOT RPTD

Drilling Journal

Narrative

Narrative	Data Source	Date	Remark
1	PI	Feb 19, 2024	STATE PAPERWORKREPERMITTED 2/16/2024
2	PI	Apr 12, 2024	STATE PAPERWORKSURF FTG CHGD FROM 651 FSL 2241 FEL, PBHL SPOT/FTG CHGD FROM SE/200 FSL 2620
3	PI	Aug 06, 2024	FEL, PROJ DEPTH CHGD FROM 21136
4	PI	Aug 06, 2024	STATE PAPERWORK INITIAL HOLE SPUD 8-2-2024 BY WYOMING CASING SERVICE #1, WORTI
5	PI	Dec 16, 2024	SKID RIG TO REYES #0211-07H; PAUSED
6	PI	Dec 23, 2024	RESUMED OPERATIONS APPROX. 12/23/2024; DRLG
7	PI	Dec 27, 2024	SKID RIG TO REYES #0211-07H; PAUSED
8	PI	Jan 02, 2025	STATE PAPERWORKWOCTI
	PI	Mar 24, 2025	FRAC 21-MAR-25

Dwights Energydata Narrative

Accumulated through 1997

Operator Address

Data Source: PI
Street or PO Box:

City: DENVER
State, Zip: CO, 82834
Country: USA
Phone:
E-Mail:

Fax:

Crossbow Joint Venture

Multi-Project Horizontal Well Development Program
Powder River Basin (Core), Campbell County, Wyoming



EAGLE
NATURAL RESOURCES

S&P

Wed Apr 02, 2025

Scout Ticket

49005777050000

General Information

0211-05H REYES

Data Source:	PI	Country:	UNITED STATES
API/UWI:	49005777050000	IC:	
State/Prov:	WYOMING	County:	CAMPBELL
Field:	UNNAMED	Operator:	EOG RESOURCES INC
Current Status:		Current Operator:	EOG RESOURCES INC
Reg. Well Status/Date:		Final Well Class:	()
Initial Class:	DEVELOPMENT WELL (D)	Target Objective:	OIL
Final Status:	TREATD	Hole Direction:	HORIZONTAL
Permit:	on Apr 01, 2021 APPROVED	Abandonment Date:	
First Report Date:	Apr 07, 2021	Projected Formation:	NIOBRARA
Projected TD:	21,402 FT	Formation at TD:	NIOBRARA
Basin:	POWDER RIVER BASIN	PRODFit Form at TD:	
Play Name:	NIOBRARA FRACTURE PLAY	Play Type:	{G} (G)

Location

Section, Twp., Range:	35 42N 73W	Data Source:	PI
Spot Code:	SE		
Footage NS EW Origin:	651 FSL 2304 FEL CONGRESS SECTION		
Principal Meridian:	6TH PRINCIPAL MRDN		
Surface Co-ord:	+387165.37 FT +1055959.27 FT	Data Source:	PI
Lat/Long:	+43.5637246 -105.5923681	Datum:	NAD27
PBH L/L:	+43.5333383 -105.6014730	Lat/Long Source:	IH
PBHL Footage NS EW Origin:	200 FSL 680 FWL CONGRESS SECTION	Lat/Long Source:	IH
PBHL Section:	11 41N 73W	Data Source:	PI
PBHL Coordinates:	From Surface: 21,402 FT	Spot:	SW
Polar:	Offset:	Data Source:	PI
Coordinate:	Y Offset: N	TVD:	10,391 FT
PBHL Coordinates:	From Surface: 21,402 FT	Azimuth:	X Offset: E
Polar:	Offset:	TVD:	10,391 FT
Coordinate:	Y Offset: 11,075 FT S	Azimuth:	X Offset: 2,414 FT W
		Data Source:	PI

Location Narrative

Data Source	Type	Remark
PI	SCALED_FOOT	REGULATORY
PI	IRREG_SECT	Y
PI	CONG_LOT	CONGRESS LOT
PI	LOCATION	SPOTTED WITH SUNDRY/REPORT LAT/LONG

Dates and Depths

Data Source:	PI	Spud Date Code:	A
Spud:	Dec 12, 2024	TD Date:	Dec 21, 2024
TD:		PlugBack Depth:	
TVD:		Formation Name TD:	NIOBRARA
Formation Code TD:	603NBRR	PRODFit Form Name TD:	
PRODFit Form Code TD:		KB. Elevation:	5,029 FT
Ref. Elevation:	5,029 FT KB	LTD:	
Ground Elevation:	5,011 FT GR		
Contractor:	ENSIGN UNITED STATES DRILLING		

Crossbow Joint Venture

Multi-Project Horizontal Well Development Program
Powder River Basin (Core), Campbell County, Wyoming



EAGLE
NATURAL RESOURCES

S&P

Wed Apr 02, 2025

Scout Ticket

Completed: Final Drilling: Dec 21, 2024
Rig Release Date: Rig #: 147
Tool: ROTARY

Production Tests

PT: 001

Data Source:	PI	Top Formation Code:	
Top Formation Name:		PRODFit Top Formation Code:	
PRODFit Top Formation Name:		Base Formation Code:	
Base Formation Name:		PRODFit Base Formation Code:	
PRODFit Base Formation Name:		Condensate:	
Oil:		Water:	
Gas:		Method:	
Interval:	-	Choke:	
Duration of Test:	Hours	GOR:	
Oil Gravity:		Cond Ratio:	
Cond Gravity:		Main Fluid Code:	
Prod Method:			

Remarks on PT Test: Data Source: PI

Casing, Liner, Tubing

Narrative	Data Source	Type	Remark
	PI	CASING	SET SURF CSG
	PI	CASING	PROD CSG NOT RPTD

Drilling Journal

Narrative

Narrative	Data Source	Date	Remark
1	PI	Nov 23, 2022	RPTD AB_LOC IN ERROR
4	PI	Aug 06, 2024	STATE PAPERWORK DRY HOLE SPUD 8-1-2024 BY WYOMING CASING SERVICE #1, WORTI
5	PI	Dec 13, 2024	DRLG
6	PI	Dec 16, 2024	SKID RIG TO REYES #0211-6H; PAUSED
7	PI	Jan 02, 2025	STATE PAPERWORK WOCT
8	PI	Mar 24, 2025	FRAC 21-MAR-25

Drilling Remark

Drilling Remark	Data Source	Date	Remark
1	PI	Feb 16, 2024	REPERMITTED 2/15/2024
2	PI	Apr 29, 2024	SURF FTG CHGD FROM 651 FSL 2281 FEL, PBHL FTG CHGD FROM 200 FSL 1400 FWL, PROJ DEPTH CHGD FROM 21296 MD
3	PI	Aug 06, 2024	INITIAL HOLE SPUD 8-1-2024 BY WYOMING CASING SERVICE #1

Dwights Energydata Narrative

Accumulated through 1997

Operator Address

Data Source: PI
Street or PO Box:
City:
DENVER

Crossbow Joint Venture

Multi-Project Horizontal Well Development Program
Powder River Basin (Core), Campbell County, Wyoming



EAGLE
NATURAL RESOURCES

S&P

Wed Apr 02, 2025

Scout Ticket

49005786200000

Project 2 (Iberlin) Scout Tickets (2 Niobrara and 2 Mowry Wells)

General Information

1-25-36MH IBERLIN STATE

Data Source:	PI	Country:	UNITED STATES
API/UWI:	49005786200000	IC:	
State/Prov:	WYOMING	County:	CAMPBELL
Field:	WILDCAT	Operator:	PEAK POWDER RIVER RESOURCES LLC
Current Status:		Current Operator:	PEAK POWDER RIVER RESOURCES LLC
Reg. Well Status/Date:		Final Well Class:	()
Initial Class:	NEW FIELD WILDCAT (WF)	Target Objective:	OIL
Final Status:	WELL PERMIT	Hole Direction:	HORIZONTAL
Permit:	on Jun 14, 2024	Abandonment Date:	
First Report Date:	Sep 21, 2023	Projected Formation:	MOWRY
Projected TD:	23,946 FT	Formation at TD:	
Basin:	POWDER RIVER BASIN	PRODFit Form at TD:	
Play Name:	MOWRY SHALE	Play Type:	{G} (G)

Location

Section, Twp., Range:	24 42N 75W	Data Source:	PI
Spot Code:	SE		
Footage NS EW Origin:	873 FSL 1642 FEL CONGRESS SECTION		
Principal Meridian:	6TH PRINCIPAL MRDN		
Lat/Long:	+43.5927372 -105.8113348	Lat/Long Source:	IH
PBH L/L:	+43.5617509 -105.8079529	Lat/Long Source:	IH
PBHL Footage NS EW Origin:	220 FSL 660 FEL CONGRESS SECTION	Datum:	NAD27
PBHL Section:	36 42N 75W	Datum:	NAD27
		Data Source:	PI
		Spot:	SE

Location Narrative

Data Source	Type	Remark
PI	SCALED_FOOT	REGULATORY
PI	IRREG_SECT	Y
PI	DST_FIELD	1.13 MI E UNNAMED FLD (FORT UNION)
PI	DST_TOWN	19.08 MI SW WRIGHT, WY
PI	SCALED_FOOT	REGULATORY
PI	IRREG_SECT	Y
PI	LOCATION	SPOTTED WITH STATE PROPOSED LAT/LONG

Dates and Depths

Data Source:	PI	Spud Date Code:	
Spud:		TD Date:	
TD:		PlugBack Depth:	
TVD:		Formation Name TD:	
Formation Code TD:		PRODFit Form Name TD:	
PRODFit Form Code TD:		KB. Elevation:	
Ref. Elevation:	5,398 FT GR	LTD:	
Ground Elevation:	5,398 FT GR	Final Drilling:	
Contractor:		Rig #:	
Completed:			
Rig Release Date:			
Tool:			

Crossbow Joint Venture

Multi-Project Horizontal Well Development Program
Powder River Basin (Core), Campbell County, Wyoming



EAGLE
NATURAL RESOURCES

S&P

Wed Apr 02, 2025

Scout Ticket

49005786230000

General Information

3-25-36NH IBERLIN STATE

Data Source:	PI	Country:	UNITED STATES
API/UWI:	49005786230000	IC:	
State/Prov:	WYOMING	County:	CAMPBELL
Field:	WILDCAT	Operator:	PEAK POWDER RIVER RESOURCES LLC
Current Status:		Current Operator:	PEAK POWDER RIVER RESOURCES LLC
Reg. Well Status/Date:		Final Well Class:	()
Initial Class:	NEW FIELD WILDCAT (WF)	Target Objective:	OIL
Final Status:	TREATD	Hole Direction:	HORIZONTAL
Permit:	on Jun 13, 2024	Abandonment Date:	
First Report Date:	Sep 21, 2023	Projected Formation:	NIOBRARA
Projected TD:	22,494 FT	Formation at TD:	NIOBRARA
Basin:	POWDER RIVER BASIN	PRODFit Form at TD:	
Play Name:	NIOBRARA FRACTURE PLAY	Play Type:	{G} (G)

Location

Section, Twp., Range:	24 42N 75W	Data Source:	PI
Spot Code:	SE		
Footage NS EW Origin:	843 FSL 1622 FEL CONGRESS SECTION		
Principal Meridian:	6TH PRINCIPAL MRDN		
Lat/Long:	+43.5926415 -105.8113012	Lat/Long Source:	IH
PBH L/L:	+43.5617388 -105.8129333	Lat/Long Source:	IH
PBHL Footage NS EW Origin:	220 FSL 1980 FEL CONGRESS SECTION	Datum:	NAD27
PBHL Section:	36 42N 75W	Datum:	NAD27
		Data Source:	PI
		Spot:	SE

Location Narrative

Data Source	Type	Remark
PI	SCALED_FOOT	REGULATORY
PI	IRREG_SECT	Y
PI	DST_FIELD	1.13 MI E UNNAMED FLD (FORT UNION)
PI	DST_TOWN	19.08 MI SW WRIGHT, WY
PI		REGULATORY
PI	IRREG_SECT	Y

Dates and Depths

Data Source:	PI	Spud Date Code:	A
Spud:	Oct 11, 2024	TD Date:	Dec 15, 2024
TD:	22,598 FT	PlugBack Depth:	
TVD:		Formation Name TD:	NIOBRARA
Formation Code TD:	603NBRR	PRODFit Form Name TD:	
PRODFit Form Code TD:		KB. Elevation:	5,422 FT
Ref. Elevation:	5,422 FT KB	LTD:	
Ground Elevation:	5,396 FT GR	Final Drilling:	Dec 15, 2024
Contractor:	NABORS DRILLING USA	Rig #:	B16
Completed:			
Rig Release Date:			
Tool:	ROTARY		

Production Tests

Crossbow Joint Venture

Multi-Project Horizontal Well Development Program
Powder River Basin (Core), Campbell County, Wyoming



EAGLE
NATURAL RESOURCES

S&P

Wed Apr 02, 2025

Scout Ticket

PT: 001

Data Source: PI

Top Formation Name:

Top Formation Code:

PRODFit Top Formation Name:

PRODFit Top Formation Code:

Base Formation Name:

Base Formation Code:

PRODFit Base Formation Name:

PRODFit Base Formation Code:

Oil:

Condensate:

Gas:

Water:

Interval:

Method:

Duration of Test: Hours

Choke:

Oil Gravity:

GOR:

Cond Gravity:

Cond Ratio:

Prod Method:

Main Fluid Code:

Remarks on PT Test: Data Source: PI

Casing, Liner, Tubing

Casing	Data Source	Size	Base Depth	Cement	PRODFit Top Formation Code	PRODFit Base Formation Code
CASING	PI	7 5/8 IN	10,574 FT			
CASING	PI	10 3/4 IN	2,219 FT			

Narrative	Data Source	Type	Remark
	PI	CASING	RAN PROD CSG

Drilling Journal

Narrative

Narrative	Data Source	Date	Remark
1	PI	Nov 19, 2024	STATE PAPERWORKDRLGI
2	PI	Feb 17, 2025	STATE PAPERWORKWOCTI
3	PI	Feb 17, 2025	FRAC 13-FEB-25

Geology Journal

Wellsite Geologist Nbr	Data Source	Remark
2	PI	R O DONENELL, B POPE

Formations

Form Code	Top Source	Interpreter	Form Name	Top Depth	Top TVD	Base Depth	Base TVD	Desc	Lithology	Age Code
604FXHL	PI		FOX HILLS	7,445	7,420			SPL		604
604LWISH	PI		LEWIS SH	7,489	7,464			SPL		604
604TCKL	PI		TECKLA	7,831	7,806			SPL		604
604TPOT	PI		TEAPOT	8,414	8,379			SPL		604
604PRKM	PI		PARKMAN	8,754	8,729			SPL		604
604STEL	PI		STEELE	9,011	8,944			SPL		604
604SSSX	PI		SUSSEX	9,881	9,802			SPL		604
604SNSD	PI		SHANNON/SD/	10,362	10,270			SPL		604
603NBRR	PI		NIOBRARA	11,305	11,259			SPL		603

Logs

Crossbow Joint Venture

Multi-Project Horizontal Well Development Program
Powder River Basin (Core), Campbell County, Wyoming



EAGLE
NATURAL RESOURCES

S&P

Wed Apr 02, 2025

Scout Ticket

49005786220000

General Information

3-25-36MH IBERLIN STATE

Data Source:	PI	Country:	UNITED STATES
API/UWI:	49005786220000	IC:	
State/Prov:	WYOMING	County:	CAMPBELL
Field:	WILDCAT	Operator:	PEAK POWDER RIVER RESOURCES LLC
Current Status:		Current Operator:	PEAK POWDER RIVER RESOURCES LLC
Reg. Well Status/Date:		Final Well Class:	()
Initial Class:	NEW FIELD WILDCAT (WF)	Target Objective:	OIL
Final Status:	TREATD	Hole Direction:	HORIZONTAL
Permit:	on Jun 14, 2024 UNAPPROVED	Abandonment Date:	
First Report Date:	Sep 21, 2023	Projected Formation:	MOWRY
Projected TD:	23,953 FT	Formation at TD:	
Basin:	POWDER RIVER BASIN	PRODFit Form at TD:	
Play Name:	MOWRY SHALE	Play Type:	{G} (G)

Location

Section, Twp., Range:	24 42N 75W	Data Source:	PI
Spot Code:	SE		
Footage NS EW Origin:	902 FSL 1663 FEL CONGRESS SECTION		
Principal Meridian:	6TH PRINCIPAL MRDN		
Lat/Long:	+43.5927992 -105.8114536	Lat/Long Source:	IH
PBH L/L:	+43.5617205 -105.8129331	Lat/Long Source:	IH
PBHL Footage NS EW Origin:	220 FSL 1980 FEL CONGRESS SECTION	Datum:	NAD27
PBHL Section:	36 42N 75W	Datum:	NAD27
		Data Source:	PI
		Spot:	SE

Location Narrative

Data Source	Type	Remark
PI	SCALED_FOOT	REGULATORY
PI	IRREG_SECT	Y
PI	DST_FIELD	1.13 MI E UNNAMED FLD (FORT UNION)
PI	DST_TOWN	19.08 MI SW WRIGHT, WY
PI		REGULATORY
PI	IRREG_SECT	Y

Dates and Depths

Data Source:	PI	Spud Date Code:	E
Spud:	Oct 28, 2024	TD Date:	Dec 04, 2024
TD:		PlugBack Depth:	
TVD:		Formation Name TD:	
Formation Code TD:		PRODFit Form Name TD:	
PRODFit Form Code TD:		KB. Elevation:	
Ref. Elevation:	5,397 FT GR	LTD:	
Ground Elevation:	5,397 FT GR		
Contractor:	NABORS DRILLING USA	Final Drilling:	Dec 04, 2024
Completed:		Rig #:	B16
Rig Release Date:	Dec 05, 2024		
Tool:	ROTARY		

Production Tests

Crossbow Joint Venture

Multi-Project Horizontal Well Development Program
Powder River Basin (Core), Campbell County, Wyoming



EAGLE
NATURAL RESOURCES

S&P

Wed Apr 02, 2025

Scout Ticket

PT: 001

Data Source:	PI	Top Formation Code:	
Top Formation Name:		PRODFit Top Formation Code:	
PRODFit Top Formation Name:		Base Formation Code:	
Base Formation Name:		PRODFit Base Formation Code:	
PRODFit Base Formation Name:		Condensate:	
Oil:		Water:	
Gas:		Method:	
Interval:	-	Choke:	
Duration of Test:	Hours	GOR:	
Oil Gravity:		Cond Ratio:	
Cond Gravity:		Main Fluid Code:	
Prod Method:			
Remarks on PT Test:	Data Source: PI		

Drilling Journal

Narrative

Narrative	Data Source	Date	Remark
1	PI	Oct 28, 2024	DRLG, TITE HOLE
2	PI	Dec 06, 2024	DRLD, TITE HOLE
3	PI	Feb 17, 2025	FRAC 13-FEB-25

Dwights Energydata Narrative

Accumulated through 1997

Operator Address

Data Source:	PI	Fax:	
Street or PO Box:			
City:	DURANGO		
State, Zip:	CO, 81301		
Country:	USA		
Phone:			
E-Mail:			
Agent Name:		Agent Code:	
Agent Remark:			

Crossbow Joint Venture

Multi-Project Horizontal Well Development Program
Powder River Basin (Core), Campbell County, Wyoming



EAGLE
NATURAL RESOURCES

S&P

Wed Apr 02, 2025

Scout Ticket

49005786210000

General Information

1-25-36NH IBERLIN STATE

Data Source:	PI	Country:	UNITED STATES
API/UWI:	49005786210000	IC:	
State/Prov:	WYOMING	County:	CAMPBELL
Field:	UNNAMED	Operator:	PEAK POWDER RIVER RESOURCES LLC
Current Status:		Current Operator:	PEAK POWDER RIVER RESOURCES LLC
Reg. Well Status/Date:		Final Well Class:	()
Initial Class:	NEW FIELD WILDCAT (WF)	Target Objective:	OIL
Final Status:	TREATD	Hole Direction:	HORIZONTAL
Permit:	on Jun 13, 2024	Abandonment Date:	
First Report Date:	Sep 21, 2023	Projected Formation:	NIOBRARA
Projected TD:	22,479 FT	Formation at TD:	NIOBRARA
Basin:	POWDER RIVER BASIN	PRODFit Form at TD:	
Play Name:	NIOBRARA FRACTURE PLAY	Play Type:	{G} (G)

Location

Section, Twp., Range:	24 42N 75W	Data Source:	PI
Spot Code:	SE		
Footage NS EW Origin:	814 FSL 1602 FEL CONGRESS SECTION		
Principal Meridian:	6TH PRINCIPAL MRDN		
Surface Co-ord:	+329228.47 FT +1066842.97 FT	Data Source:	PI
Lat/Long:	+43.5925640 -105.8112249	Lat/Long Source:	IH
PBH L/L:	+43.5617509 -105.8079537	Lat/Long Source:	IH
PBHL Footage NS EW Origin:	220 FSL 660 FEL CONGRESS SECTION	Datum:	NAD27
PBHL Section:	36 42N 75W	Datum:	NAD27
PBHL Coordinates:	From Surface: 22,479 FT	Data Source:	PI
Polar:	Offset:	Spot:	SE
Coordinate:	Y Offset: N	TVD:	11,582 FT
ABHL Footage NS EW Origin:	226 FSL 716 FEL CONGRESS SECTION	Azimuth:	
ABHL Section:	36 42N 75W	X Offset:	E
		Data Source:	PI
		Spot:	SE

Location Narrative

Data Source	Type	Remark
PI	SCALED_FOOT	REGULATORY
PI	IRREG_SECT	Y
PI	DST_FIELD	1.13 MI E UNNAMED FLD (FORT UNION)
PI	DST_TOWN	19.08 MI SW WRIGHT, WY
PI		REGULATORY
PI	IRREG_SECT	Y

Dates and Depths

Data Source:	PI	Spud Date Code:	A
Spud:	Nov 15, 2024	TD Date:	Nov 29, 2024
TD:	22,420 FT	PlugBack Depth:	
TVD:	11,623 FT	Formation Name TD:	NIOBRARA
Formation Code TD:	603NBRR	PRODFit Form Name TD:	
PRODFit Form Code TD:		KB. Elevation:	5,422 FT
Ref. Elevation:	5,422 FT KB	LTD:	
Ground Elevation:	5,396 FT GR		

Crossbow Joint Venture

Multi-Project Horizontal Well Development Program
Powder River Basin (Core), Campbell County, Wyoming



EAGLE
NATURAL RESOURCES

S&P

Wed Apr 02, 2025

Scout Ticket

Contractor: NABORS DRILLING USA
Completed: Final Drilling: Nov 29, 2024
Rig Release Date: Rig #: B16
Tool: ROTARY

Production Tests

PT: 001

Data Source:	PI	Top Formation Code:	
Top Formation Name:		PRODFit Top Formation Code:	
PRODFit Top Formation Name:		Base Formation Code:	
Base Formation Name:		PRODFit Base Formation Code:	
PRODFit Base Formation Name:		Condensate:	
Oil:		Water:	
Gas:		Method:	
Interval:	-	Choke:	
Duration of Test:	Hours	GOR:	
Oil Gravity:		Cond Ratio:	
Cond Gravity:		Main Fluid Code:	
Prod Method:			
Remarks on PT Test:	Data Source: PI		

Casing, Liner, Tubing

Casing	Data Source	Size	Base Depth	Cement	PRODFit Top Formation Code	PRODFit Base Formation Code
CASING	PI	10 3/4 IN	2,235 FT	579 SACK		
CASING	PI	16 IN	105 FT			
CASING	PI	5 1/2 IN	22,409 FT	727 SACK		
CASING	PI	7 5/8 IN	10,592 FT	570 SACK		

Drilling Journal

Narrative

Narrative	Data Source	Date	Remark
1	PI	Nov 19, 2024	STATE PAPERWORKDRLGI
2	PI	Feb 18, 2025	STATE PAPERWORKWOCTI
3	PI	Feb 17, 2025	FRAC 13-FEB-25

Geology Journal

Wellsite Geologist Nbr	Data Source	Remark
2	PI	R O DONNELL, B POPE, E MANN

Formations

Form Code	Top Source	Interpreter	Form Name	Top Depth	Top TVD	Base Depth	Base TVD	Desc	Lithology	Age Code
604FXHL	PI		FOX HILLS	7,435	7,382			SPL		604
604LWIS	PI		LEWIS	7,532	7,017			SPL		604
604TCKL	PI		TECKLA	8,033	7,975			SPL		604
604TPOT	PI		TEAPOT	8,433	8,372			SPL		604
604PRKM	PI		PARKMAN	8,769	8,702			SPL		604
604STEL	PI		STEELE	9,011	8,944			SPL		604
604SSSX	PI		SUSSEX	9,881	9,802			SPL		604
604SNSD	PI		SHANNON/SD/	10,362	10,260			SPL		604



PROVEN HISTORY

Jeremy A. Paul - Founder/CEO, Eagle Natural Resources, LLC

Jeremy is 35 years old with over 15 years experience in the oil and gas sector with a proven track record of taking advantage of market opportunities to create value and returns for investors. He has built Eagle Natural Resources to an almost \$100 million valuation with interest or outright ownership in over 600 wells across six states.

Mr. Paul has spent a great deal of time and energy within lower risk re-development projects where an infusion of capital in proven, producing field and an existing stable of wells will deliver solid return potential. With experience in all phases of upstream development including drilling, testing, completing, acidizing, hydraulic fracturing, and enhanced oil recovery techniques, Mr. Paul combines this experience with his knowledge of land and lease opportunities to implement plans designed to increase daily production and overall returns. Over his career, Mr. Paul has strategically balanced investor capital into a variety of projects to maximize return potential while minimizing risk.

Prior to forming Eagle Natural Resources, LLC, Mr. Paul provided consulting services to other independent Oil & Gas producers, overseeing the start-up and expansion of their private equity departments.

Jeff Spurl - Geophysicist/Geologist

Jeff graduated with Highest Distinction with a Bachelor of Science degree in Geophysics from Penn State University in 1985 and began his career in petroleum exploration with Amoco Production Company in New Orleans, Louisiana. He became a lead subsurface interpreter and prospect generator at Apache Corporation, BHP Americas and Amoco Production Company, focusing on field acquisition and re-development; prospect generation; 2-D or 3-D seismic selection, acquisition, processing and interpretation; subsurface integration; pre-drill volume calculation, risk analysis and targeting.